



Model: iB37

# Color Changing Over Ear Headphones

## with In-Line Mic and Remote and Rechargeable, Multi-Mode Lighting Effects



### Using Your iHome Color Changing Headphones

The L and R markings are located on the inside of the headband. When worn properly the headphone cable with in-line mic will be on your left side. The two ear cups may be adjusted up or down for most comfortable fit.

Connect the headphone plug to the headphone jack of your music player. Be sure that the plug is fully inserted into the jack. If the plug is not fully inserted you may only hear sound from one side of the headphones.

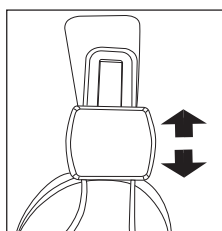

To protect your hearing, always start listening with the volume control of your smartphone or music player set to a low level and gradually increase the volume to a comfortable listening level.

**IMPORTANT!** Listening at high volume for long periods of time can result in long-term hearing damage. For your safety, do not use headphones if they would prevent you from hearing warning sounds, such as while driving a car or motorcycle, riding a bike, etc. Remember that studio monitor style headphones such as the iB37 may block outside noise, including warning sounds. Always be aware of your surroundings and do not use these headphones in situations that require you to hear warning sounds.

### Rechargeable Color-Changing Lighting Effects

Your iHome Color Changing headphones feature color changing LED's inside the headband that will illuminate the clear acrylic brackets attached to the ear cups.

These color changing LED's are powered by a built in rechargeable battery that can power the lighting system for up to 24 hours when fully charged. A USB charging cable was included with your headphones. Although the built in battery was fully charged when the headphones left our factory, like all rechargeable batteries it can experience some loss of charge during periods of non-use. We recommend that you charge the built-in battery for 3 hours before initial use.

**NOTE:** The built in battery provides power only to the lighting effects, not to the headphone itself. The headphones will operate normally regardless of the built-in battery condition.

To charge the built in battery, make sure that the lighting ON/OFF switch is set to the OFF position. Connect the micro USB plug of the supplied cable to the micro USB port on the bottom of the 'L' ear cup as shown, then connect the larger USB plug to a powered USB port on a notebook computer or to any USB/AC adapter.

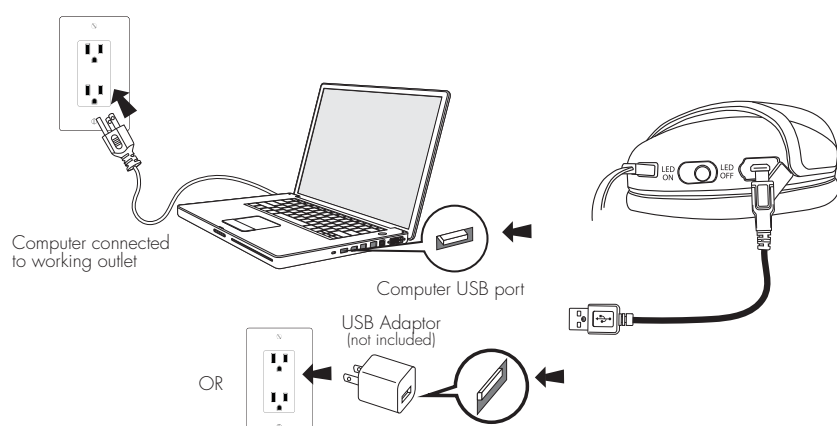

The headphone lighting will glow a soft red color while the battery is charging. The lighting will shut off when the battery is fully charged.

**NOTE:** If the battery is low the headphone lighting will flash red on and off for 5 seconds when you set the ON/OFF switch to the ON position. This is your reminder to charge the battery. However, even if the battery is completely drained and the lighting will not turn on, the headphones will still operate normally.

To turn on the lighting effects slide the ON/OFF switch to the 'On' position.

Your iHome Color Changing headphones provide 4 different lighting effects that are selected by pressing the LED MODE button. The lighting effects are:

1. Color Spectrum – the colors blend evenly and smoothly.
2. Favorite Color – press the LED MODE button when your favorite color appears to stop the color blending and maintain your favorite color.
3. Strobe to the Beat – the changing colors will flash to the beat of the music.
4. Color Pulse – rapid changing of colors with no blending.

Your iHome GlowTunes headphones will remember the mode that was selected before the lighting effect was switched 'Off' and automatically return to that same mode when the lighting effect is switched 'On' again.

When you no longer want your iHome Color Changing headphones to display colors, slide the ON/OFF switch to the 'Off' position. This will shut off the lighting effects but the headphones will still operate normally.

### In-Line Control with Microphone

Model iB37 includes an in-line, one-button controller that allows you to answer and end phone calls 'hands-free'. You may also be able to control various phone functions using voice commands and/or control the music playback if your specific phone model provides for control of those features through the headphone jack.

### Answer / End Calls

When an incoming call is received, briefly press the controller button once to answer the call and speak into the microphone. To end the call, briefly press the controller button again.

### Music Playback Control

If your phone or music player provides for this feature through its headphone jack press the controller button once to begin playback and once again to pause playback. Press the controller button twice to skip to the next track, or three times to restart the current track or go to the previous track (depending on how close you are to the start of the track).

### Voice Commands

If your phone or music player provides for this feature through its headphone jack, press and hold the controller button to activate your device's voice commands menu. Once your device has launched the voice command menu you may then speak your instructions into the microphone, accessing features such as hands-free messaging, navigation, voice memo recording, and more. For the specific commands and operations accessible through your device's headphone jack, please refer to the user manual of your device.

**NOTE:** Not all of the hands free functions are available on all phones. You may find that some functions may work with your phone while others do not. This is due to the design of your specific phone and is not an indication of any problem with the iB37 headphone.

### Use of the Hangtag Cord Wrap

- 1 Remove hangtag from package.
- 2 Unfold hangtag.

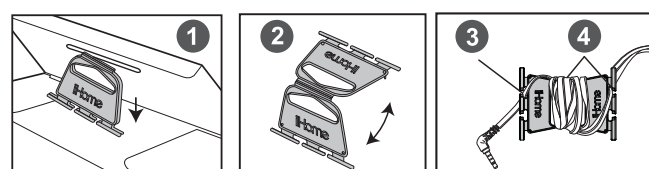

- 3 Insert cable at plug end into one of the slots on one end of the hangtag.
- 4 Wrap cable around middle of hangtag as desired and insert remainder through slot on other end of hangtag.

### Limited 1 Year Warranty

iHome Products, a division of SDI Technologies Inc. (hereafter referred to as SDI), warrants this product to be free from defects in workmanship and materials, under normal use and conditions, for a period of one (1) year from the date of original purchase.

Should this product fail to function in a satisfactory manner, it is best to first return it to the store where it was originally purchased. Should this fail to resolve the matter and service still be required by reason of any defect or malfunction during the warranty period, SDI will repair or, at its discretion, replace this product without charge. This decision is subject to verification of the defect or malfunction upon delivery of this product to the Factory Service Center authorized by Customer Service.

If service is required, please call Customer Service at 1-800-288-2792 to obtain a Return Authorization Number and shipping instructions.

### Disclaimer of Warranty

**NOTE:** This warranty is valid only if the product is used for the purpose for which it was designed. It does not cover (i) products which have been damaged by negligence or willful actions, misuse or accident, or which have been modified or repaired by unauthorized persons; (ii) cracked or broken cabinets, or units damaged by excessive heat; (iii) damage to digital media players, CD's or tape cassettes (if applicable); (iv) the cost of shipping this product to the Factory Service Center and its return to the owner.

This warranty is valid only in the United States of America and does not extend to owners of the product other than to the original purchaser. In no event will SDI or any of its affiliates, contractors, resellers, their officers, directors, shareholders, members or agents be liable to you or any third party for any consequential or incidental damages, any lost profits, actual, exemplary or punitive damages. (Some states do not allow limitations on implied warranties or exclusion of consequential damages, so these restrictions may not apply to you.) This warranty gives you specific legal rights, and you may also have other rights which vary from state to state.

Your acknowledgment and agreement to fully and completely abide by the above mentioned disclaimer of warranty is contractually binding to you upon your transfer of currency (money order, cashier's check, or credit card) for purchase of your SDI product.

© 2015 SDI Technologies, Inc. All rights reserved.  
Questions? Visit [www.ihome.com](http://www.ihome.com)  
or call 1-800-288-2792 Toll Free