

iHome

POWERCLOCK

Bluetooth Speaker + Two USB Charging Ports



Model iBT235

QUESTIONS? visit www.ihome.com

WELCOME

Thank you for choosing the iBT235 from iHome. This user guide will get you up and running quickly. For more information about this and other iHome products, please visit **www.ihome.com**

GETTING STARTED

This unit ships with the following items. Please check to see that all items are present.

1. iBT235 alarm clock
2. AC power adapter



1. iBT235



2. AC adapter

CONNECTING THE IBT235

Plug the included AC adapter into the DC jack on the back of the unit and connect the plug to a working outlet not controlled by a light switch.

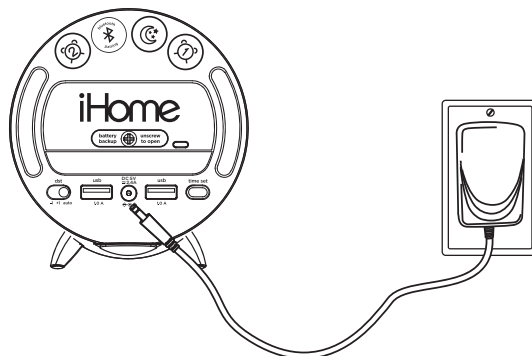

FEATURES & FUNCTIONS

TOP PANEL

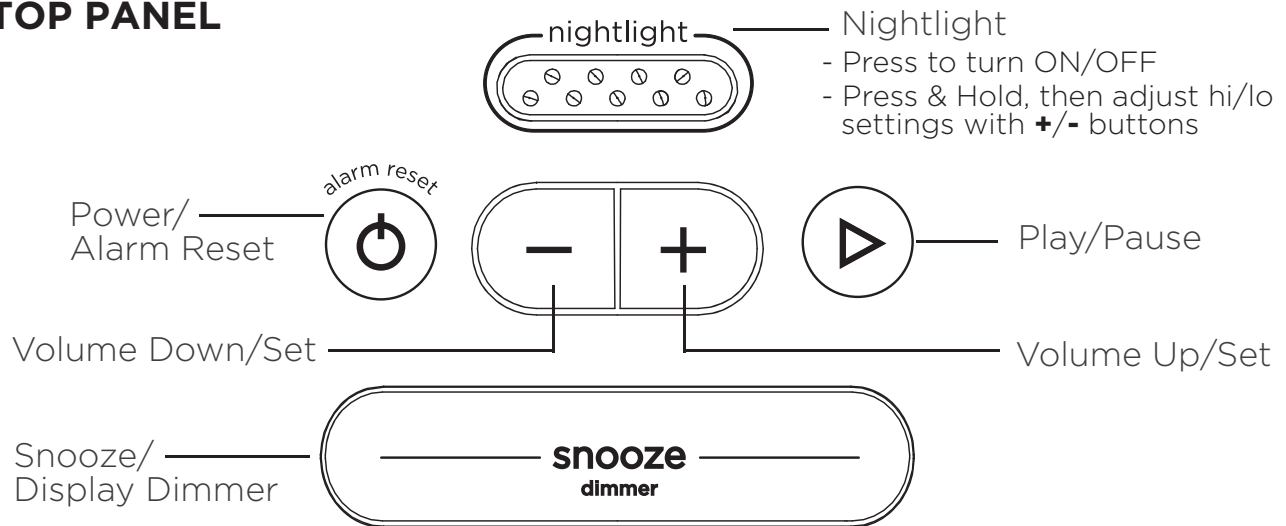

CLOCK DISPLAY

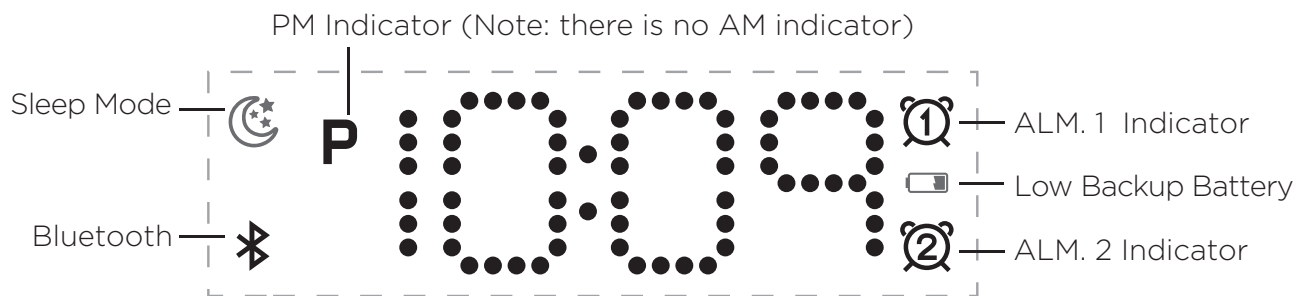

BACK PANEL

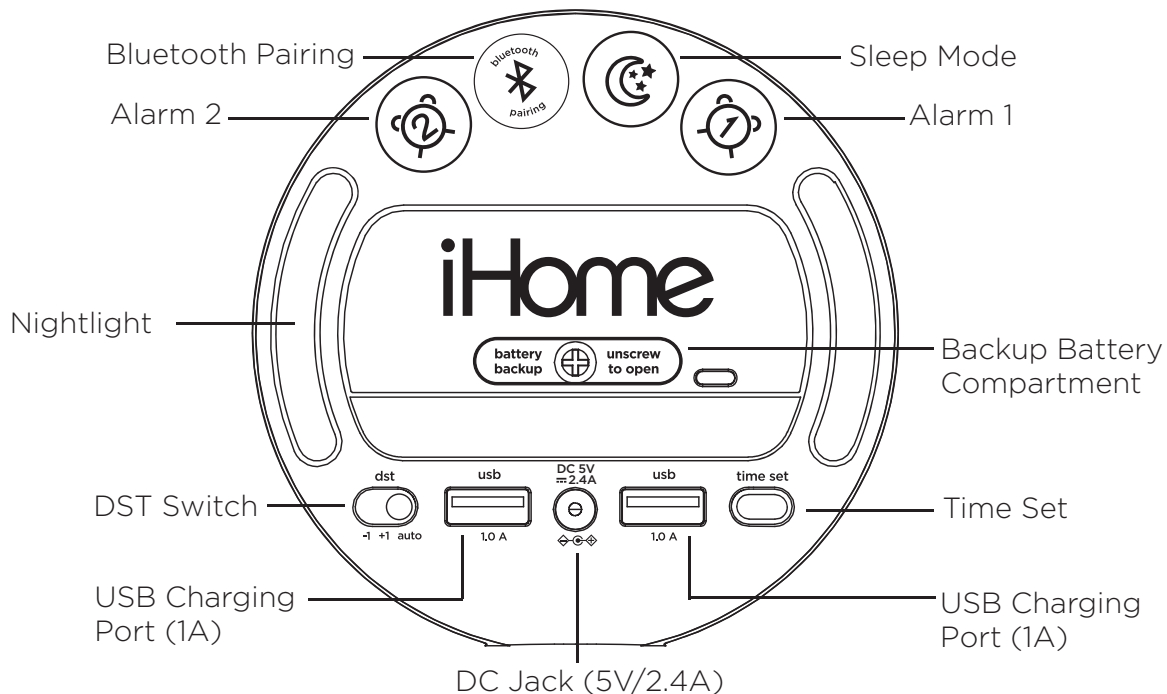

SETTING THE TIME

1. Press and hold the **⌚ Time Set Button** located on the back of the unit for 2 seconds until the clock display flashes and a beep sounds.
2. Press the **-** or **+** **Buttons** to adjust the clock to the current time (hold for rapid setting). Make sure you set the correct AM/PM time. The PM indicator appears to the left of the display; there is no AM indicator.
3. To toggle the clock display between standard 12 hour time and 24 hour (“military”) time display, press the **⌚ Alarm** or **⌚ Alarm Button** while the display is flashing during time setting.
4. Press and release the **⌚ Time Set Button** to confirm the current time setting. The YEAR will flash on the display. Press the **-** or **+** **Buttons** to set the correct year.
5. Press and release the **⌚ Time Set Button** to confirm the current year setting. The Date will flash on the display. Press the **-** or **+** **Buttons** to set the correct month and day (hold for rapid adjustment).
6. Press and release the **⌚ Time Set Button** to confirm the current date setting. 2 beeps will sound to indicate time setting mode is complete.

DST SWITCH: This unit has a **DST switch** on the back of the unit to adjust the time for daylight saving time and standard time. By default, it is set to Auto and will automatically adjust the time at the start and end of daylight saving time. If you wish to adjust manually, slide the switch to +1 to add one hour or to -1 to subtract an hour.

SETTING THE ALARMS

This unit features dual alarms which can be set to different times and alarm sources. Each is set in the same way. Instructions are given as ‘Alarm Button’ - press Alarm 1 or Alarm 2 to set respective alarms.

1. Press and hold the **Alarm Button** for 2 seconds until the alarm time display and alarm icon flash.
2. Press the **-** or **+** **Buttons** to adjust the alarm time (hold for rapid setting). Make sure you set the correct AM/PM alarm time. The PM indicator appears to the left of the time display. (There is no AM indicator.)
3. Press the **Alarm Button** to confirm the alarm time setting. Press the **-** or **+** **Buttons** to set the desired alarm schedule: 7 Days (every day), 5 Days (week days only) or 2 Days (weekends only).

Continued on next page...

SETTING THE ALARMS (CONTINUED)

4. Press the **Alarm Button** to confirm the alarm schedule. Press the **-** or **+** **Buttons** to select the desired wake to alarm source:

Wake to Bluetooth: Wake to a linked Bluetooth device.

(Note: Be sure to adjust the volume on your Bluetooth device.)

Wake to Tone: Press the **Alarm Button** to confirm. Press the **-** or **+** **Buttons** to select one of four tones.

5. Press the **Alarm Button** to confirm the alarm source.
6. Press the **-** or **+** **Buttons** to adjust the alarm volume.
7. Press the **Alarm Button** to confirm settings. The corresponding **Alarm Indicator** (1 or 2) will appear on the display to confirm the alarm is armed.

TURNING THE ALARM ON/OFF

1. Press the **Alarm Button** to preview the alarm time. Press again toggle the alarm ON and OFF, indicated by the related LED indicator.
2. When the alarm sounds, press the corresponding **Alarm Button (1 or 2)** or the **Alarm Reset Button** to disable the alarm and reset it for the next day.

SNOOZE/DIMMER

Snooze: When the alarm is sounding, press the **Snooze/Dimmer Button** to snooze the alarm for 9 minutes.

Dimmer: Press the **Snooze/Dimmer Button** (when alarm is NOT sounding) to adjust the display brightness.

PROGRAMMABLE SNOOZE

Set the duration of your snooze timer:

1. To program Snooze, press and hold the **Snooze/Dimmer Button** for 2 seconds during normal operation (when no alarm is sounding).
2. Press the **-** or **+** **Buttons** to select the desired snooze time (between 1 and 29 minutes).
3. Press the **Snooze/Dimmer Button** to confirm setting. You can snooze the alarm repeatedly for up to one hour.

BLUETOOTH PAIRING

Make sure your device is 'discoverable' by turning on Bluetooth mode. The first time the iBT235 is powered on, it will automatically enter pairing mode.

To manually pair your Bluetooth device:

1. Press and hold the Bluetooth Button on the back of the iBT235 for 2 seconds.

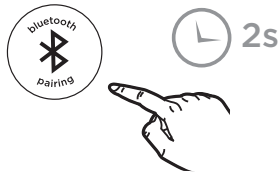

2. Select 'iHome iBT235' on your device's Bluetooth menu to connect.

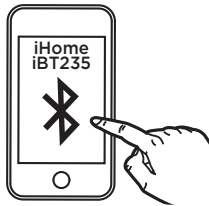

3. If pairing is successful, the Bluetooth indicator appears on the iBT235 display, indicating the unit is ready to play music.

To reset Bluetooth settings, press and hold the Bluetooth Button for 10 seconds.

Playing Bluetooth Audio:

1. Press the **Play/Pause Button** on the unit to play or pause audio from your linked Bluetooth device.
2. Press the **-** or **+** **Buttons** to adjust the volume on the unit.

CHARGING DEVICES VIA USB

- Connect a USB cable (not included) to one of the two USB ports located on the back of the unit to charge devices.
- Monitor the charging on your device. Some devices use a proprietary charging method and will not charge using the USB port. If this happens, you must charge your device using the charger that came with it.

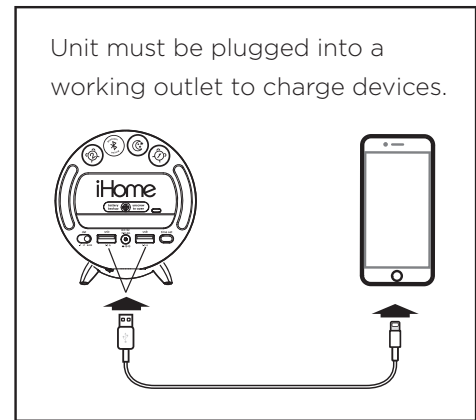

BATTERY BACK-UP

The unit comes with a CR-2450 back-up battery installed to maintain clock settings in the event of a temporary power failure. Remove the battery pull tab before use. When the battery icon on the display is flashing, it is time to replace the back-up battery.

1. Make sure the AC adapter is connected, or you will lose your clock settings during battery replacement.
2. Use a Phillips screwdriver to unscrew the battery compartment door.
3. Remove the exhausted battery and insert a new CR2450 battery.
4. Replace the compartment door. Do not overtighten the screw.

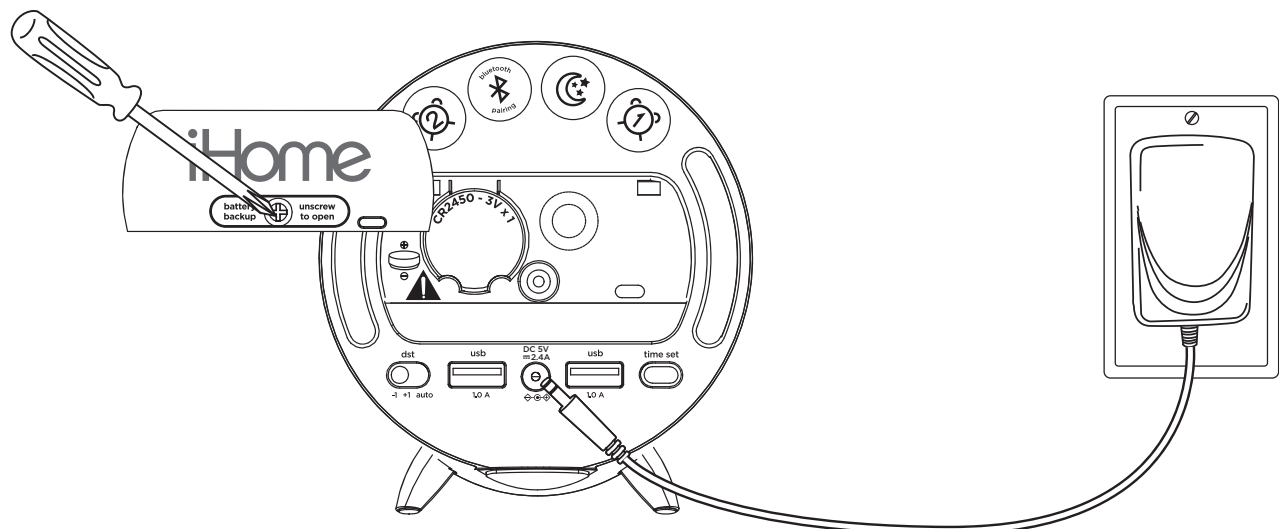

BATTERY USE CAUTION AND TIPS

- Only use the recommended/supplied batteries or equivalent.
- Use alkaline batteries for longer life.
- Insert batteries with proper polarity (+/-) as indicated.
- Remove exhausted batteries from product.
- Recharge rechargeable batteries under adult supervision.
- Do not attempt to recharge non-rechargeable batteries.
- Do not open batteries or heat them beyond normal ambient temperatures.
- To prevent battery leakage or damage remove batteries from a product if it will not be used for a month or longer.
- Use extreme caution handling leaking batteries (avoid direct contact with eyes and skin). If battery leakage comes in contact with eyes, IMMEDIATELY flush the eye with lukewarm and gently flowing water for at least 30 minutes. If skin contact occurs, wash skin with clear water for at least 15 minutes. Seek medical attention if any symptoms occur.
- Store in cool, dry, ventilated area away from hazardous or combustible material.
- Follow applicable laws and local regulations for the disposal of batteries.

MAINTENANCE

- Place the unit on a level surface away from sources of direct sunlight or excessive heat.
- Remove plastic protective film from the clock display.
- Protect your furniture when placing your unit on a natural wood and lacquered finish. A cloth or other protective material should be placed between it and the furniture.
- Clean your unit with a soft cloth moistened only with mild soap and water. Stronger cleaning agents such as thinner or similar materials can damage the surface of the unit.

IMPORTANT SAFETY INSTRUCTIONS

When used in the directed manner, this unit has been designed and manufactured to ensure your personal safety. However, improper use can result in potential electrical shock or fire hazards. Please read and follow all safety and operating instructions carefully before installation and use, and keep these instructions handy for future reference. Take special note of all warnings listed in these instructions and on the unit.

1. Water and Moisture – The unit should not be used near water. For example: near a bathtub, washbowl, kitchen sink, laundry tub, swimming pool or in a wet basement.
2. Ventilation – The unit should be situated so that its location or position does not interfere with its proper ventilation. For example, it should not be situated on a bed, sofa, rug or similar surface that may block ventilation openings. Also, it should not be placed in a built-in installation, such as a bookcase or cabinet, which may impede the flow of air through the ventilation openings.
3. Heat – The unit should be situated away from heat sources such as radiators, heat registers, stoves or other appliances (including amplifiers) that produce heat.
4. Power Sources – The unit should be connected to a power supply only of the type described in the operating instructions or as marked on the appliance. Only use the AC adapter that came with the unit.
5. Power-Cable Protection – Power supply cables should be routed so that they are not likely to be walked on or pinched by items placed upon or against them. It is always best to have a clear area from where the cable exits the unit to where it is plugged into an AC socket.
6. Cleaning – The unit should be cleaned only as recommended. See the Maintenance section for cleaning instructions.
7. Objects and Liquid Entry – Care should be taken so that objects do not fall and liquids are not spilled into any openings or vents located on the product.
8. Attachments – Do not use attachments not recommended by the product manufacturer.
9. Lightning and Power Surge Protection – Unplug the unit from the wall socket and disconnect the antenna or cable system during a lightning storm or when it is left unattended and unused for long periods of time. This will prevent damage to the product due to lightning and power-line surges.
10. Damage Requiring Service – The unit should be serviced by qualified service personnel when:
 - A. the power supply cable or plug has been damaged.
 - B. objects have fallen into or liquid has been spilled into the enclosure.
 - C. the unit has been exposed to rain.
 - D. the unit has been dropped or the enclosure damaged.
 - E. the unit exhibits a marked change in performance or does not operate normally.
11. Periods of Nonuse – If the unit is to be left unused for an extended period of time, such as a month or longer, remove batteries before storage
12. Servicing – The user should not attempt to service the unit beyond those methods described in the user manual. Service methods not covered in the operating instructions should be referred to qualified service personnel.
13. Magnetic Interference: This product's speakers contain powerful magnets which could cause interference or damage to sensitive equipment such as hard drives, CRT televisions and monitors, as well as medical, scientific, and navigational devices. Keep this unit away from these products at all times.
14. Only use attachments/accessories specified by the manufacturer. This product is suitable for use in tropical and/or moderate climates.
15. No naked flame sources, such as lighted candles, should be placed on the apparatus.
16. WARNING: To reduce the risk of fire or electric shock, do not expose this product to rain or moisture
17. Do not dispose of batteries in the household trash or fire.
18. The mains plug of power adaptor is used as the disconnect device, it shall remain readily operable.
19. Clean only with dry cloth.

LIMITED ONE YEAR WARRANTY

iHome Products, a division of SDI Technologies Inc. (hereafter referred to as SDI), warrants this product to be free from defects in workmanship and materials, under normal use and conditions, for a period of one (1) year from the date of original purchase. Should this product fail to function in a satisfactory manner, it is best to first return it to the store where it was originally purchased. Should this fail to resolve the matter and service still be required by reason of any defect or malfunction during the warranty period, SDI will repair or, at its discretion, replace this product without charge. This decision is subject to verification of the defect or malfunction upon delivery of this product to the Factory Service Center authorized by Customer Service.

If service is required, please contact Customer Service at ihome.com/support/contact to obtain a Return Authorization Number and shipping instructions. A copy of the sales receipt is required to validate in-warranty coverage.

Disclaimer of Warranty

NOTE: This warranty is valid only if the product is used for the purpose for which it was designed. It does not cover (i) products which have been damaged by negligence or willful actions, misuse or accident, or which have been modified or repaired by unauthorized persons; (ii) cracked or broken cabinets, or units damaged by excessive heat; (iii) damage to digital media players, CD's or tape cassettes (if applicable); (iv) the cost of shipping this product to the Factory Service Center and its return to the owner.

This warranty is valid only in the United States of America and does not extend to owners of the product other than to the original purchaser. In no event will SDI or any of its affiliates, contractors, resellers, their officers, directors, shareholders, members or agents be liable to you or any third party for any consequential or incidental damages, any lost profits, actual, exemplary or punitive damages. (Some states do not allow limitations on implied warranties or exclusion of consequential damages, so these restrictions may not apply to you.) This warranty gives you specific legal rights, and you may also have other rights which vary from state to state. Your acknowledgment and agreement to fully and completely abide by the above mentioned disclaimer of warranty is contractually binding to you upon your transfer of currency (money order, cashier's check, or credit card) for purchase of your SDI product.