

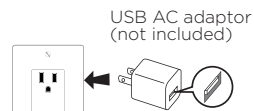

## 1 CHARGE EACH SPEAKER BEFORE USE



USB AC adaptor  
(not included)

OR



Computer USB port

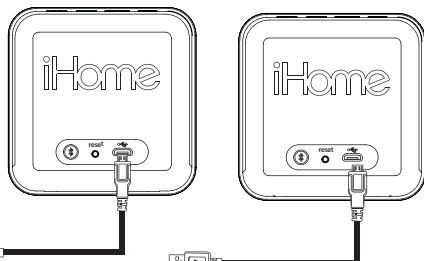

### Charging Indicator LED

- Flashing RED = low battery
- Solid RED = charging
- Off = fully charged

2 USB charging cables included

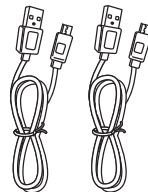

## 2 GETTING STARTED: WIRELESS STEREO

### LEFT SPEAKER

### RIGHT SPEAKER

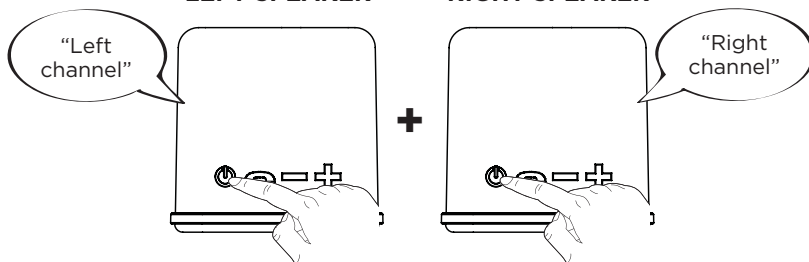

**Press and hold the Power Button on each speaker to power on units within 10 seconds to establish Wireless Stereo link.**

The GREEN Wireless Stereo indicator on front of each speaker will flash green then turn solid and each speaker will announce a channel identity when the 2 speakers are linked.

The unit will then enter autopairing mode, or search for a previously paired Bluetooth device.

### WS Indicator LED

- Flashing GREEN = linking
- Solid GREEN = linked

## 3 BLUETOOTH MODE

### Bluetooth Indicator LED

- Flashing BLUE = pairing
- Solid BLUE = paired

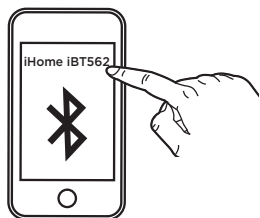

**THE FIRST TIME THE UNIT IS POWERED ON**  
Once the WS link is established, the speakers enter auto pairing mode, indicated by tones and the Bluetooth indicator flashing BLUE.

Select "iHome iBT562" on your device's Bluetooth menu to complete pairing.

### MANUAL PAIRING/PAIRING SPEAKERS SEPARATELY (MONO)

To pair speakers after first power on or to pair separately



Press and hold the **Power Button** to turn speaker(s) ON

Press and hold the **Bluetooth Button** on left speaker

Select "iHome iBT562"

### SPEAKERPHONE MODE (Left Speaker only)

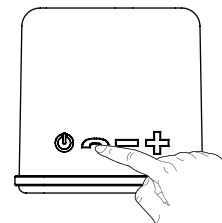

Press to answer or end call  
Press and hold to ignore calls

Adjust Volume  
(turn up your device first)

## Charging the iBT562

The iBT562 is powered by a rechargeable battery in each speaker.

**MAKE SURE TO CHARGE EACH SPEAKER BEFORE USE**

- Connect the micro-USB plug on one of the included charging cables to the USB Charging Jack on one speaker. Repeat for the remaining speaker.
- Connect each charging cable to a powered USB port, such as that on a computer or USB AC adapter. The computer or USB AC adapter should be connected to a wall outlet when speaker is charging. The Charging LED on each speaker will turn solid red while charging and turn off when fully charged.
- If the LED flashes red, or you notice sound distortion at higher volumes, or there is no sound at all, it's time to recharge the battery.

## Wireless Stereo and Bluetooth

Each iBT562 speaker is pre-synced to the other at the factory for Wireless Stereo (WS) operation. You just need to turn both speakers on within 10 seconds to establish a WS link. An audio prompt will identify each channel, and the unit will enter Bluetooth pairing mode.

**Note:** Once speakers are linked, powering off one speaker will also turn the other speaker off.

- Once WSS link is established, the Bluetooth indicator will flash blue and pairing tones will sound. Select "iHome iBT562" on the device's Bluetooth menu. If prompted, enter pass code 1234.
- The Bluetooth indicator will glow solid blue, indicating pairing is successful. You are now ready to stream your audio. Control and navigate tracks on your Bluetooth device. Press the **-/+ Buttons** on either speaker to control volume. Once the iBT562 is paired it will attempt to autolink when the device is within Bluetooth range (about 33 feet).

**Note:** To save battery power, the unit will power off automatically after 5 minutes with no audio detected or no BT connection.

### Manual Bluetooth Pairing

To pair manually, power on each speaker, then **press and hold the Bluetooth Button** located on the back of the left speaker for 2 seconds. Select "iHome iBT562" on the device's Bluetooth menu.

### Pairing with a Single Speaker (Mono Operation)

To use a single speaker, just turn one on instead of both and follow steps to pair. If a single paired speaker is playing and the other speaker is powered on it will attempt WS linking then play in stereo mode. **Note:** If more than one device is paired to a single speaker, connecting to the speaker on one device will disconnect the other device.

## Using the iBT562 Speakerphone Mode

The speaker must be on and connected to a paired Bluetooth phone to receive calls. In WS mode, the left speaker controls the speakerphone. When a call comes in, any playing audio is paused, the Status LED will flash blue 2X and the ringtone associated with the caller may sound, depending on Bluetooth device.

- Press the **Phone Button** to answer or end a call.
- Press and hold for 2 seconds to ignore a call.