

# iHome®



**CHARGE  
BEFORE  
USE**



iBT3  
(iBT5 with included bike mount)

***Splashproof  
Bluetooth Wireless  
Speaker  
with Speakerphone***



instruction  
manual

Questions? Contact Customer Service at 1-800-288-2792

## Introduction

Thank you for purchasing the iHome iBT3. This product is designed to provide high quality wireless sound for your iPad, iPhone, iPod, computer, or other Bluetooth audio device. A bike mount is included for sound on the go.

This instruction booklet explains the basic operation and care of the unit. Please read it carefully and keep for future reference.

## IMPORTANT INFORMATION ABOUT SPLASH RESISTANT USE

**For proper splash-resistant operation, make sure the seal on the left side of the unit is completely flush with the unit by pressing along the entire edge of the seal until it is completely and securely in place.**

- The unit is IPX4 rated, meaning it will repel a stream of water for up to 5 minutes.
- DO NOT immerse the unit in water.
- Make sure seal and surrounding surfaces are completely dry before opening seal to prevent moisture from damaging the internal electronics.
- Keep seal free of dirt, sand, or other objects that can interfere with proper sealing. If for any reason the seal is not making a tight seal, water may enter the unit.
- DO NOT clean unit with oily soaps or use chemicals or solvents. Clean with damp cloth.

**WARNING:** batteries (battery pack or batteries installed) shall not be exposed to excessive heat such as sunshine, fire or the like.

## Table of Contents

Included/ Meet Your iBT3/Status indicator .....	1-3
Attaching Carry Strap .....	4
Installing Bike Mount .....	5
Getting Started: Charging the unit .....	6
Using Bluetooth: Pairing Your Device .....	7
Pairing with a Different Device/ Playing Audio Via Bluetooth .....	8
Speakerphone Operation .....	9
Playing Audio via Aux In .....	10-11
Consumer Product Safety Guide .....	12
Troubleshooting .....	13
Warranty .....	14

# iBT3

(iBT5 with included bike mount)

## Included

- iBT3 system
- micro USB charging cable
- carrying strap
- bike mount

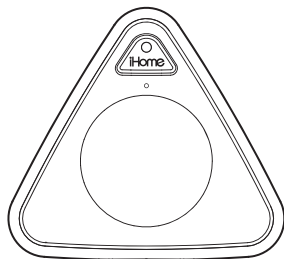

iBT3 system



micro USB charging  
cable

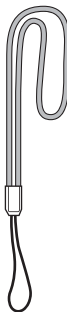

carrying  
strap

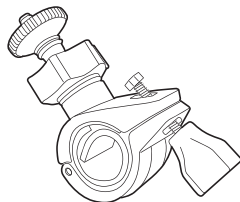

bike mount

# Meet Your iBT3

# iBT3

## Right Side

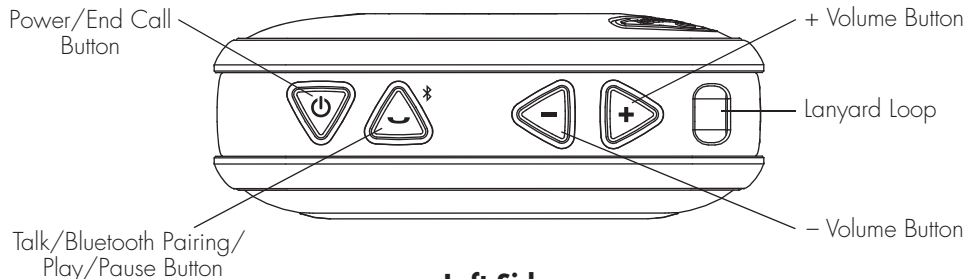

## Left Side

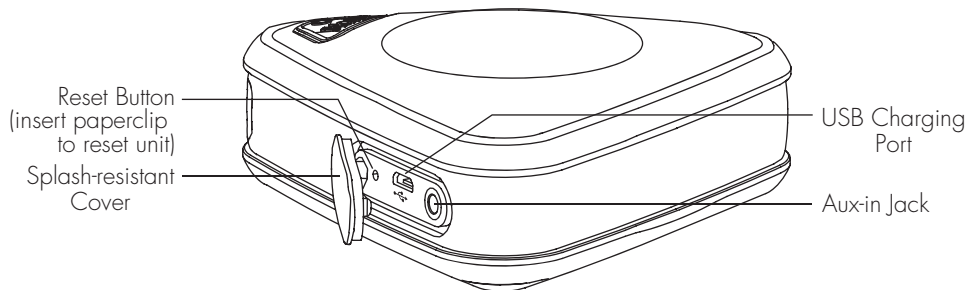

*TIP:* On some iOS (Apple) devices, you can view the iBT3 battery status on your device's screen. When device is paired and connected, look for a vertical battery icon next to the Bluetooth icon on the upper right corner of the device's screen.



Status indicator

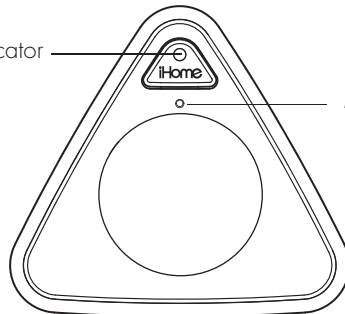

Microphone

Status indicator	Status
Solid red LED	Unit is charging
Flashing red LED*	Unit needs charging
Solid blue LED	Active Bluetooth connection / Aux mode
Quickly flashing blue LED	Unit is attempting to pair with Bluetooth device
Slowly flashing blue LED	Unit is attempting to auto link to already paired Bluetooth device

\*Flashes red 10x every minute

# Using the iBT3

## Getting Started: Attaching the Carry Strap

A carrying strap is included with the iBT3 for easy carrying or attaching to a backpack, etc.

To attach the strap, insert the small loop through the loop channel on top of the unit then pull the large loop through the small loop.

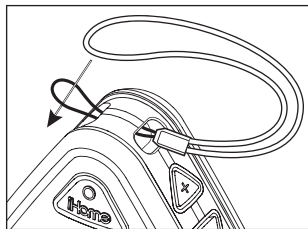

### **Bottom**

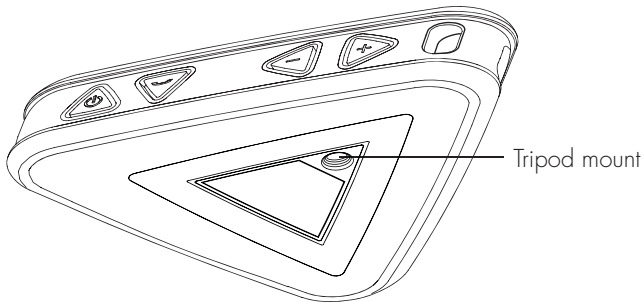

The threaded tripod mount on the bottom of the iBT3 allows you to mount the unit to the included bicycle mount for sound on the go. See directions on next page to attach unit to bike mount.

**Caution: Remain aware of your surroundings and do not ride bike or operate unit in an unsafe manner. Do not attempt pairing or adjustments while bike is in motion.**

## Installing the Bike Mount (no tools required)

# Using the iBT3 (iBT5 with included Bike mount)

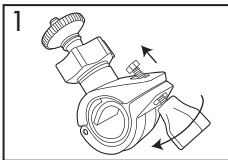

1. Remove **bolt** from **mounting clamp** by turning **plastic nut** left/counter clockwise. Set bolt and plastic nut aside.

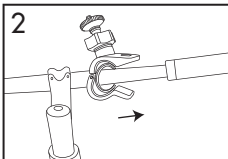

2. Place **mounting clamp** around handlebar or stroller handle. Test the fit by re-inserting **bolt** and replacing **plastic nut** (turn right/clockwise). Do not overtighten.

IF handle is too large (plastic nut does not engage the bolt), remove the rubber spacers inside the mounting clamp and try again.

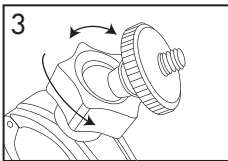

3. Loosen pivot nut by turning left (counterclockwise). Adjust pivot to desired angle, then tighten pivot nut.

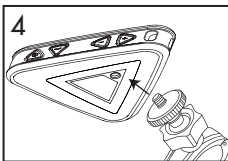

4. Guide threaded **pivot bolt** on top of bike mount into threaded socket on the bottom of iBT3 and turn device right/clockwise to tighten.



# Using the iBT3

## Getting Started: Charging the Unit

Charge unit before use. For first time charge, charge for at least 3 hours.

Pull back splash-proof seal and connect the included micro USB cable to the USB Charging Port on the left side of the unit and connect the other standard USB plug to a computer, USB AC adaptor (not included) or other USB power source.

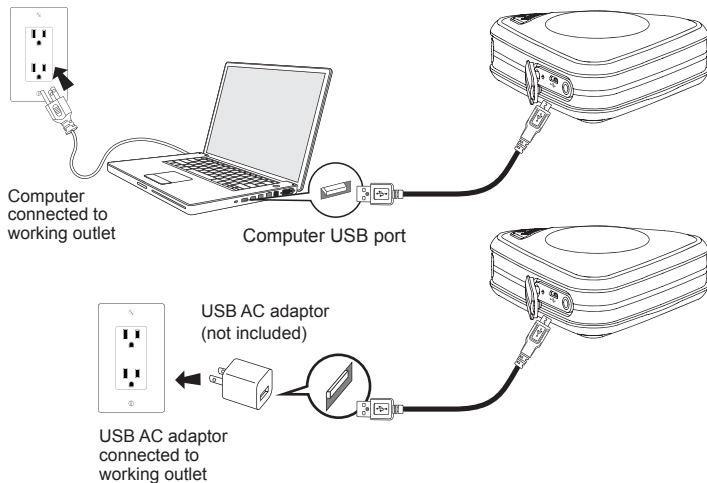



## Pairing Your Device

# Using the iBT3

Pairing is the set-up process to introduce your Bluetooth-capable device to the iBT3. Once your device is paired, the iBT3 can recognize it and you can play your audio through it.



1. Make sure your Bluetooth device is fully charged. Turn on your Bluetooth device and make it “discoverable” by turning on Bluetooth mode (check in Options or Settings).
2. Press the  **Power Button** to turn on the iBT3. The first time the unit is powered on, it will enter auto-pairing mode and attempt to connect to a Bluetooth device. Otherwise, follow step 3 to begin pairing.
3. Press and hold the  **Talk/Pairing/Play/Pause Button** on the right of the unit for 2 seconds. The unit will beep twice and the status indicator LED will flash blue, indicating the unit is in pairing mode.
4. “iHome iBT3” should appear in your device’s Bluetooth menu. If “Not Paired”, “Not Connected” or similar message appears, select “iHome iBT3” to connect it. If prompted for a passcode, enter “1234” on your device’s keypad.

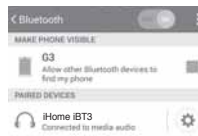
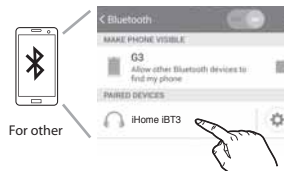
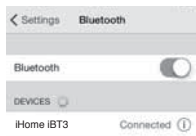
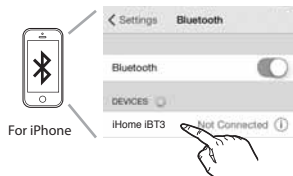



5. If pairing is successful, a tone will sound and the Bluetooth indicator light will glow solid, indicating the iBT3 is ready to play music. There should also be an indication on your device. If no device is successfully paired within 3 minutes the iBT3 will default to previous mode. Once the iBT3 is paired to a device, it will attempt to autolink when the device is within range (about 30 feet).

## Pairing with a Different Device



When you power ON the speaker, it will automatically link with the previously paired Bluetooth device as long as that device is still within range (approx. 30 feet). To pair with a different device follow steps 1 - 4 under "Pairing Your Device" on previous page.

## Playing Audio Via Bluetooth

1. Press the  **Power Button** to turn on the unit. The status indicator will glow solid blue when a linked device is in range and detected. You can then listen to audio streamed wirelessly from your paired iPad, iPhone, iPod or other Bluetooth device.
2. Press the  **Talk/Pairing/Play/Pause Button** to play audio from your device. Press again to pause play and once more to resume play. When Bluetooth audio is active, the status indicator will glow solid blue.
3. Use menu and track controls on your Bluetooth device to navigate tracks.
4. Press the **-** or **+** **Button** to adjust the iBT3 volume. A confirmation tone will sound when minimum or maximum volume is reached. You can also adjust volume on your device.
5. When done listening, press the  **Power Button** to turn the unit OFF. Remember to turn off your device, too.



## Speakerphone Operation

NOTE: The unit must be powered and linked to a Bluetooth phone to receive a call.

1. When a call is received, playing music is muted to hear the ring tone. Press the  **Talk/Bluetooth/Play/Pause Button** to answer the call, or press the  **Power/End Call Button** to ignore it. For call waiting function, use phone controls on your device.
2. When a call is completed, press the  **Power/End Call Button** to end the call and resume previous function.

# Using the iBT3

## Playing Audio via Aux In

1. Connect one end of a 3.5mm audio cable (not included) to the Aux-in jack on the left side of the unit and connect the other end to the headphone or line-out jack on your audio device.
2. Press the  **Power Button** on the unit to turn it on.
3. Power on the audio device and use the controls on the device to play or pause audio, and navigate tracks.
4. Press the **-** or **+** **Button** to adjust the system volume. You can also adjust volume on your device.
5. When done listening, press the  **Power Button** to turn the unit OFF. Remember to turn off your device, too.

**NOTE:** Make sure no Bluetooth device is playing when you want to hear Aux-in or you will hear Bluetooth instead of Aux-in.

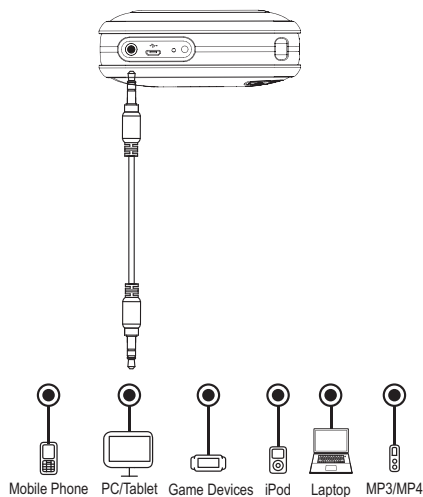

## IMPORTANT SAFETY INSTRUCTIONS

When used in the directed manner, this unit has been designed and manufactured to ensure your personal safety. However, improper use can result in potential electrical shock or fire hazards. Please read all safety and operating instructions carefully before installation and use, and keep these instructions handy for future reference. Take special note of all warnings listed in these instructions and on the unit.

1. **Water and Moisture** – This unit is rated iPX4 (will withstand a stream of water for up to 5 minutes), but should not be operated in or under water.
  - Splash-resistant cover must be properly sealed before use near water.
  - Dry unit completely before opening splash resistant cover.
  - Do NOT open cover if wet or in a wet environment.
2. **Ventilation** – The unit should be situated so that its location or position does not interfere with its proper ventilation. For example, it should not be situated on a bed, sofa, rug or similar surface that may block ventilation openings. Also, it should not be placed in a built-in installation, such as a bookcase or cabinet, which may impede the flow of air through the ventilation openings.
3. **Heat** – The unit should be situated away from heat sources such as radiators, heat registers, stoves or other appliances (including amplifiers) that produce heat.
4. **Power Sources** – The unit should be connected to a power supply only of the type described in the operating instructions or as marked on the appliance.
5. **Power-Cable Protection** – Power supply cables should be routed so that they are not likely to be walked on or pinched by items placed upon or against them.
6. **Cleaning** – The unit should be cleaned only using a warm damp cloth. Do not use solvents, etc.

7. **Objects and Liquid Entry** – Care should be taken so that objects do not fall and liquids are not spilled into any openings or vents located on the product. Keep splash-resistant cover free of dirt, sand, or objects that could interfere with a proper seal.
8. **Attachments** – Do not use attachments not recommended by the product manufacturer.
9. **Lightning and Power Surge Protection** – Unplug the unit from the wall socket and disconnect the antenna or cable system during a lightning storm or when it is left unattended and unused for long periods of time. This will prevent damage to the product due to lightning and power-line surges.
10. **Overloading** – Do not overload wall sockets, extension cords, or integral convenience receptacles as this can result in a risk of fire or electric shock.
11. **Damage Requiring Service** – The unit should be serviced by qualified service personnel when:
  - A. the power supply cable or plug has been damaged.
  - B. objects have fallen into or liquid has been spilled into the enclosure.
  - C. the unit has been exposed to rain.
  - D. the unit has been dropped or the enclosure damaged.
  - E. the unit exhibits a marked change in performance or does not operate normally.
12. **Periods of Nonuse** – If the unit is to be left unused for an extended period of time, such as a month or longer, make sure to charge the unit before storing and periodically during storage to maintain battery.
13. **Servicing** – The user should not attempt to service the unit beyond those methods described in the user's operating instructions. Service methods not covered in the operating instructions should be referred to qualified service personnel.

Questions? Visit [www.ihome.com](http://www.ihome.com)  
or call 1-800-288-2792 Toll Free

## FCC/IC Information

### FCC Radiation Exposure Statement

This equipment complies with FCC RF radiation exposure limits set forth for an uncontrolled environment. This transmitter must not be colocated or operating in conjunction with any other antenna or transmitter.

This device complies with Industry Canada licence-exempt RSS standard(s). Operation is subject to the following two conditions:

- (1) This device may not cause interference, and
- (2) This device must accept any interference, including interference that may cause undesired operation of the device.

**This device complies with Part 15 of the FCC Rules, operation is subject to the following two conditions:**

- (1) This device may not cause harmful interference, and**
- (2) this device must accept any interference received, including interference that may cause undesired operation.**

- Warning: Changes or modifications to this unit not expressly approved by the party responsible for compliance could void the user's authority to operate the equipment.
- NOTE: This equipment has been tested and found to comply with the limits for a Class B digital device, pursuant to Part 15 of the FCC Rules.

These limits are designed to provide reasonable protection against harmful interference in a residential installation. This equipment generates, uses and can radiate radio frequency energy and, if not installed and used in accordance with the instructions, may cause harmful interference to radio communications.

However, there is no guarantee that interference will not occur in a particular installation. If this equipment does cause harmful interference to radio or television reception, which can be determined by turning the equipment off and on, the user is encouraged to try to correct the interference by one or more of the following measures:

- Reorient or relocate the receiving antenna.
- Increase the separation between the equipment and receiver.
- Connect the equipment into an outlet on a circuit different from that to which the receiver is connected.
- Consult the dealer or an experienced radio/TV technician for help.

#### CAN ICES-3 (B)/NMB-3(B)

The device meets the exemption from the routine evaluation limits in section 2.5 of RSS 102 and compliance with RSS-102 RF exposure, users can obtain Canadian information on RF exposure and compliance.



# Troubleshooting

## Unit doesn't respond (no power)

- Check that unit is fully charged.
- Make sure your device is properly paired with the iBT3.
- Make sure the **Power** is ON.

## Unit doesn't respond (locked up or frozen)

If the unit does not respond, insert the end of a paperclip or similar into the Reset Button located under the splash proof cover to reset the unit.

## Resetting Bluetooth

If Bluetooth function is not operating properly, you may wish to reset Bluetooth. To do so, *press and hold* the  **Power Button** for 10 seconds. You will hear a long high tone. You will need to re-pair your paired devices.

## Trouble pairing device/computer with iBT3

Bluetooth implementation varies depending on your device's hardware and operating system. Please see our website for updates on pairing.

- Make sure you have the latest firmware for your device.
- Make sure your device is working properly. Check your device's manual for details on Bluetooth pairing and linking.
- When you power ON the speaker, it will automatically link with the last previously paired Bluetooth device if the device is still within range (approx.30 feet). To pair with a different device *press and hold* the  **Talk/Pairing/Play/Pause Button** for 2-3 seconds.

For further information and to see the latest instructions, visit [www.ihome.com/support](http://www.ihome.com/support)

# Limited 1 Year Warranty

iHome Products, a division of SDI Technologies Inc. (hereafter referred to as SDI), warrants this product to be free from defects in workmanship and materials, under normal use and conditions, for a period of one (1) year from the date of original purchase. Should this product fail to function in a satisfactory manner, it is best to first return it to the store where it was originally purchased. Should this fail to resolve the matter and service still be required by reason of any defect or malfunction during the warranty period, SDI will repair or, at its discretion, replace this product without charge. This decision is subject to verification of the defect or malfunction upon delivery of this product to the Factory Service Center authorized by Customer Service. If service is required, please call Customer Service at 1-800-288-2792 to obtain a Return Authorization Number and shipping instructions.

## Disclaimer of Warranty

NOTE: This warranty is valid only if the product is used for the purpose for which it was designed. It does not cover (i) products which have been damaged by negligence or willful actions, misuse or accident, or which have been modified or repaired by unauthorized persons; (ii) cracked or broken cabinets, or units damaged by excessive heat; (iii) damage to digital media players, CD's or tape cassettes (if applicable); (iv) the cost of shipping this product to the Factory Service Center and its return to the owner. This warranty is valid only in the United States of America and does not extend to owners of the product other than to the original purchaser. In no event will SDI or any of its affiliates, contractors, resellers, their officers, directors, shareholders, members or agents be liable to you or any third party for any consequential or incidental damages, any lost profits, actual, exemplary or punitive damages. (Some states do not allow limitations on implied warranties or exclusion of consequential damages, so these restrictions may not apply to you.) This warranty gives you specific legal rights, and you may also have other rights which vary from state to state. Your acknowledgment and agreement to fully and completely abide by the above mentioned disclaimer of warranty is contractually binding to you upon your transfer of currency (money order, cashier's check, or credit card) for purchase of your SDI product.

© 2015 SDI Technologies, Inc. All rights reserved

Questions? Visit [www.ihome.com](http://www.ihome.com)  
or call 1-800-288-2792 Toll Free