

iHome®

Model: iBT682



***True Wireless Stereo
Color Changing
Rechargeable
Bluetooth Speakers
with Speakerphone***



**CHARGE
BEFORE
USE**

Introduction

Thank you for purchasing the iHome iBT682. This product is designed to provide True Wireless stereo sound for your Bluetooth audio device. Each speaker can also be used separately. This instruction booklet explains the basic operation and care of the unit. Please read them carefully and keep for future reference.

Maintenance

- Place the unit on a level surface away from sources of direct sunlight or excessive heat.
- Protect your furniture when placing your unit on a natural wood and lacquered finish. A cloth or other protective material should be placed between it and the furniture.
- Clean your unit with a soft cloth moistened only with mild soap and water. Stronger cleaning agents, such as benzene, thinner or similar materials can damage the surface of the unit.

iBT682

What's Included

- 2 x iBT682 speakers
- 2x USB charging cables

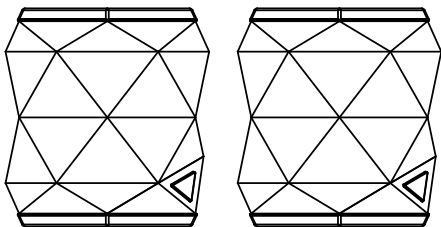

iBT682 speakers

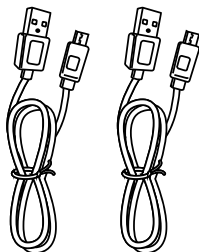

USB charging cables

iBT682

Meet Your iBT682

Top

NOTE: only one of the two speakers is show below; they are identical.



Blue/Green Status Indicator Light
Blue = Bluetooth Status
(single speaker)
Green = True Wireless Mode
Bluetooth Status
(both speakers)

Front

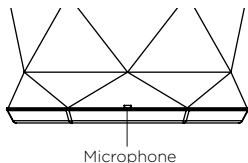

Bottom

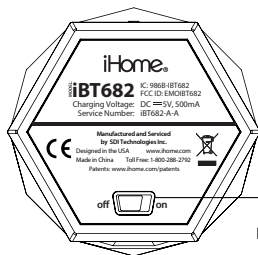

Power off/on Switch

Back

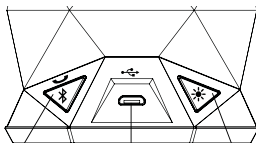

Bluetooth/
Speakerphone
Button

USB
Charging
Port

Color Mode
Button

Getting Started: Charging the Speakers

CHARGE UNIT BEFORE USE/KEEP UNIT OFF FOR FASTER CHARGING

1. Connect the micro USB plug on the included combination cable to the micro USB Charging/Aux-in USB Port on the side of the unit.
2. Connect the standard USB plug end of the cable to a powered USB port on a computer, a USB AC adaptor or other USB charging device. For first time use, charge each speaker for about 4 hours. The red charge status indicator LED on top of the speaker glows while speaker is charging.

Note: When unit is ON and not charging, the LED flashing red indicates low battery (speaker needs charging).

Charge via computer USB port, USB AC adaptor or other powered USB port

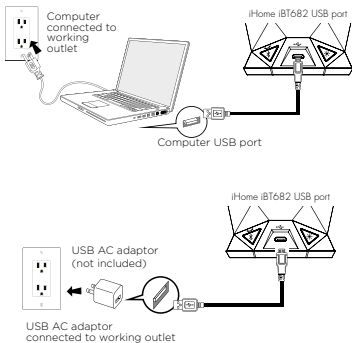

TIP: On some iOS (Apple) devices, you can view the iBT682 battery status on your device's screen. When device is paired and connected, look for a vertical battery icon next to the Bluetooth icon on the upper right corner of the device's screen.



Using the **iBT682**

Getting Started: First Time Use True Wireless Stereo

Each of your iBT682 speakers are pre-synced to one another for True Wireless stereo operation. This sync is permanent (neither speaker can be synced with a different or third speaker). True Wireless link range is about 5 meters (about 16 feet). If one of the speakers is moved out of True Wireless range, the stereo link between the two speakers will fail.

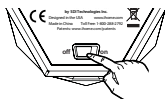

Left Speaker



Right Speaker

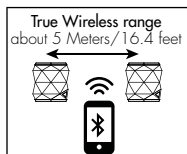

Power ON both speakers within 10 seconds for True Wireless

Slide the **Power Off/On Switch** located on the bottom of each speaker to ON to turn it on and start True Wireless link. Tones will sound and each speaker will flash green while attempting to establish a link. The indicator on the top of each speaker will glow green when the True Wireless stereo link is successful and an audio prompt will identify each speaker as left channel or right channel. After successful True Wireless linking, the speakers will enter Bluetooth pairing mode (see below). After first time power on, user must pair manually (see page 6).

NOTE: Once speakers are linked, powering **OFF** one speaker will also turn the other speaker off. To turn that speaker back on, move the **Power Off/On Switch** to OFF then back to ON.

Using the iBT682

Bluetooth: Pairing Your Device the First Time

Pairing is the set-up process to introduce your Bluetooth-capable device to the iBT682. Once your device is paired, the speakers can recognize it and you can play your audio through them. Turn on your Bluetooth device and make it “discoverable” by turning on Bluetooth mode (check in Options or Settings).

- The first time both speakers are turned on, after establishing the True Wireless link, the speakers will enter auto-pairing mode and attempt to connect to a Bluetooth device. The status indicator light on the top of each speaker will flash quickly and the left speaker will flash blue.
- “iHome iBT682” should appear in your device’s Bluetooth menu. Select “iHome iBT682” to connect it. If prompted for a passcode, enter “1234” on your device’s keypad.

If pairing is successful, 1 beep will sound and the status indicator light will appear solid on each speaker, indicating the iBT682 is ready to play music. There should also be an indication on your device. If no device is successfully paired within 3 minutes the iBT682 will default to standby mode. Once the iBT682 is paired to a device, it will attempt to autolink when the device is within Bluetooth range (about 33 feet).

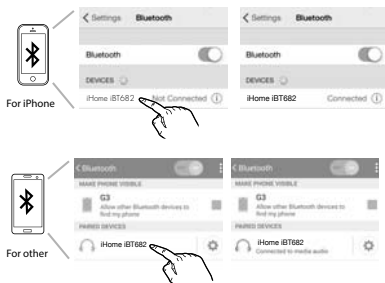

Manual Pairing

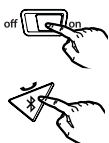

1. Slide the **Power Off/On** Switch on each speaker to ON. True Wireless linking should take about 10 seconds.
2. Press and hold the Bluetooth Button (located on the back) on the left speaker for 2 seconds.
3. Select “iHome iBT682” on your device’s Bluetooth menu to complete pairing.

Using the iBT682

Pairing with a Single iBT682 Speaker (Mono Operation)



To use a single speaker, just turn one on instead of both. To use both speakers separately, place each outside of True Wireless range (about 16 feet) then turn on and pair each speaker separately with a different device. When separately paired speakers are returned to within True Wireless range, each will maintain separate pairing unless one is powered off then powered back on, in which case it will attempt True Wireless linking. Note: Each separately paired speaker will appear on your device as "iHome iBT682" (just as when you pair both speakers together). You can select the desired instance or remove "iHome iBT682" and re-pair unit(s) again.

Playing Audio Via Bluetooth

1. Slide the **Power Off/On** Switch on BOTH speakers to **ON** within 10 seconds. Following True Wireless linking, the Bluetooth status indicator will glow solid blue when a linked device is in range and detected. You can then listen to audio streamed wirelessly from your paired Bluetooth device.
2. Use controls on your Bluetooth device to adjust volume and to play, pause and navigate tracks.
3. When done listening, slide the **Power Off/On** Switch to **OFF** on both speakers.

Speakerphone Operation

NOTE: The unit must be powered on and linked to a Bluetooth phone to receive a call.

1. When a call is received, playing music is muted to hear the ring tone and the cabinet lights flash green. Press the  **Bluetooth/Speakerphone** Button to answer the call, or press and hold to reject the call. For call waiting function, press the button again to answer a second call, and once more to return to the original call. Press and hold to end the current call and return to a remaining call.
2. When a call is completed, press the  **Bluetooth/Speakerphone** Button to end the call and resume previous function.

Using the iBT682

Using Color Modes

There are five color modes, which you cycle through in this order:

- a. Slow Fade (colors slowly fade from one into the next)
 - b. Fast Change (colors change rapidly)
 - c. One Color (select a favorite color)
 - d. Pulse to Music (lights flash to the beat of the music)
 - e. Off (no display)
1. Slide the **Power Off/On** Switch to **ON** to turn the unit ON.
 2. Press the  **Color Mode** Button repeatedly on either speaker to cycle to the desired color mode. For One Color mode, first cycle to Fast Change mode then press the Color Mode Button when the desired color appears. For Pulse to Music, make sure the volume on your connected Bluetooth device is above 50%.
 3. When done, slide the **Power Off/On** Switch to **OFF** to turn the unit OFF.

Troubleshooting

Unit doesn't respond (no power)

- Make sure unit is completely charged.
- Check that all connections are correct and properly plugged in.
- Make sure your device is properly paired with the iBT682.
- Make sure the unit is on

Unit doesn't respond (locked up/ "frozen")

If the unit does not respond, try resetting the unit. Press and hold the Bluetooth Button for about 10 seconds. Note that doing so will clear settings, and any Bluetooth devices will need to be re-paired.

Trouble pairing device with iBT682

Bluetooth implementation varies depending on your device's hardware and operating system. Please see our website for updates on pairing.

- When you power ON the speaker, it will automatically link with the last previously paired Bluetooth device if the device is still within range (about 33 feet). To pair with a different device you must turn off Bluetooth capability on the already paired device, or take it out of range.
- If your device does not auto-link when within range, re-pair the device. To do so, first delete the iBT682 from your Bluetooth devices menu.
- Make sure your device is working properly. Check your device's manual for details on Bluetooth pairing and linking.

**For further information and to see the latest instructions, visit
www.ihome.com/support**

© 2016 SDI Technologies, Inc. All rights reserved
Questions? Visit www.ihome.com
or call 1-800-288-2792 Toll Free

Internal Rechargeable Lithium-ion Battery

This device uses an internal rechargeable lithium-ion battery that should last the lifetime of the device. If you suspect your battery may be dead, try charging it several times. If the battery does not recharge, please contact **Customer Service at -1-800-288-2792.**

WARNING/DISPOSAL OF UNIT

Please do NOT attempt to change the battery yourself. Doing so may damage the unit and will void the warranty. When disposing of unit, follow the disposal instructions below:

- Never dispose of used batteries/electronics with ordinary solid wastes, since they contain toxic substances.
- Always dispose of used batteries/electronics in accordance with the prevailing community regulations that apply to the disposal of batteries/electronics. If there are no local regulations concerning battery/electronics disposal, please dispose of the device in a waste bin for electronic devices.
- Many electronics retailers now recycle batteries and other electronic components at no charge. Check to see which ones in your area do so.

CAUTION

The battery used in this device may present a risk of fire, explosion or chemical burn if mistreated

- Never use or charge the battery if it appears to be leaking, discolored, deformed, or in any way abnormal.
- Never disassemble the unit or attempt to remove battery as that could cause leakage of alkaline solution or other electrolytic substance.
- Always confirm that the temperature is 5°C – 35° C (41° - 95° Fahrenheit) before you charge the battery. Leakage or deterioration of the battery may occur if this warning is not heeded.
- Never expose the battery to any liquid.
- Never expose the battery to excessive heat such as direct sunlight or fire. Never use the battery pack in an unventilated vehicle where excessive internal temperatures may be encountered.
- Always keep the battery out of the reach of infants and small children.

FCC Information

iBT682

FCC ID: EMOIBT682

IC: 986B-iBT682

FCC Radiation Exposure Statement

This equipment complies with FCC RF radiation exposure limits set forth for an uncontrolled environment.

This device complies with Part 15 of the FCC Rules, operation is subject to the following two conditions: (1) This device may not cause harmful interference, and (2) this device must accept any interference received, including interference that may cause undesired operation.

- Warning: Changes or modifications to this unit not expressly approved by the party responsible for compliance could void the user's authority to operate the equipment.
- NOTE: This equipment has been tested and found to comply with the limits for a Class B digital device, pursuant to Part 15 of the FCC Rules.

These limits are designed to provide reasonable protection against harmful interference in a residential installation. This equipment generates, uses and can radiate radio frequency energy and, if not installed and used in accordance with the instructions, may cause harmful interference to radio communications.

However, there is no guarantee that interference will not occur in a particular installation. If this equipment does cause harmful interference to radio or television reception, which can be determined by turning the equipment off and on, the user is encouraged to try to correct the interference by one or more of the following measures:

- Reorient or relocate the receiving antenna.
- Increase the separation between the equipment and receiver.
- Connect the equipment into an outlet on a circuit different from that to which the receiver is connected.
- Consult the dealer or an experienced radio/TV technician for help.

CAN ICES-3 (B)/NMB-3(B)

Canada Statement

This device complies with Industry Canada's licence-exempt RSSs. Operation is subject to the following two conditions:

- (1) This device may not cause interference; and
- (2) This device must accept any interference, including interference that may cause undesired operation of the device.

Le présent appareil est conforme aux CNR d'Industrie Canada applicables aux appareils radio exempts de licence. L'exploitation est autorisée aux deux conditions suivantes :

- (1) l'appareil ne doit pas produire de brouillage;**
- (2) l'utilisateur de l'appareil doit accepter tout brouillage radioélectrique subi, même si le brouillage est susceptible d'en compromettre le fonctionnement.**

The device meets the exemption from the routine evaluation limits in section 2.5 of RSS 102 and compliance with RSS-102 RF exposure, users can obtain Canadian information on RF exposure and compliance.

Le dispositif rencontre l'exemption des limites courantes d'évaluation dans la section 2.5 de RSS 102 et la conformité à l'exposition de RSS-102 rf, utilisateurs peut obtenir l'information canadienne sur l'exposition et la conformité de rf.

Consumer Product Safety Guide

IMPORTANT SAFETY INSTRUCTIONS

When used in the directed manner, this unit has been designed and manufactured to ensure your personal safety. However, improper use can result in potential electrical shock or fire hazards. Please read all safety and operating instructions carefully before installation and use, and keep these instructions handy for future reference. Take special note of all warnings listed in these instructions and on the unit.

1. **Water and Moisture** – The unit should not be used near water. For example: near a bathtub, washbowl, kitchen sink, laundry tub, swimming pool or in a wet basement.
2. **Ventilation** – The unit should be situated so that its location or position does not interfere with its proper ventilation. For example, it should not be situated on a bed, sofa, rug or similar surface that may block ventilation openings. Also, it should not be placed in a built-in installation, such as a bookcase or cabinet, which may impede the flow of air through the ventilation openings.
3. **Heat** – The unit should be situated away from heat sources such as radiators, heat registers, stoves or other appliances (including amplifiers) that produce heat.
4. **Power Sources** – The unit should be connected to a power supply only of the type described in the operating instructions or as marked on the appliance. Only use the AC adapter that came with the unit.
5. **Power-Cable Protection** – Power supply cables should be routed so that they are not likely to be walked on or pinched by items placed upon or against them. It is always best to have a clear area from where the cable exits the unit to where it is plugged into an AC socket.
6. **Cleaning** – The unit should be cleaned only as recommended. See the Maintenance section of this manual for cleaning instructions.
7. **Objects and Liquid Entry** – Care should be taken so that objects do not fall and liquids are not spilled into any openings or vents located on the product.
8. **Attachments** – Do not use attachments not recommended by the product manufacturer.
9. **Lightning and Power Surge Protection** – Unplug the unit from the wall socket and disconnect the antenna or cable system during a lightning storm or when it is left unattended and unused for long periods of time. This will prevent damage to the product due to lightning and power-line surges.
10. **Overloading** – Do not overload wall sockets, extension cords, or integral convenience receptacles as this can result in a risk of fire or electric shock.
11. **Damage Requiring Service** – The unit should be serviced by qualified service personnel when:
 - A. the power supply cable or plug has been damaged.
 - B. objects have fallen into or liquid has been spilled into the enclosure.
 - C. the unit has been exposed to rain.
 - D. the unit has been dropped or the enclosure damaged.
 - E. the unit exhibits a marked change in performance or does not operate normally.
12. **Periods of Nonuse** – If the unit is to be left unused for an extended period of time, such as a month or longer, charge the unit fully before storage.
13. **Servicing** – The user should not attempt to service the unit beyond those methods described in the user's operating instructions. Service methods not covered in the operating instructions should be referred to qualified service personnel.
14. **Magnetic Interference**: This product's speakers contain powerful magnets which could cause interference or damage to sensitive equipment such as hard drives, CRT televisions and monitors, as well as medical, scientific, and navigational devices. Keep this unit away from these products at all times.

LIMITED 1 YEAR WARRANTY

iHome Products, a division of SDI Technologies Inc. (hereafter referred to as SDI), warrants this product to be free from defects in workmanship and materials, under normal use and conditions, for a period of one (1) year from the date of original purchase.

Should this product fail to function in a satisfactory manner, it is best to first return it to the store where it was originally purchased. Should this fail to resolve the matter and service still be required by reason of any defect or malfunction during the warranty period, SDI will repair or, at its discretion, replace this product without charge. This decision is subject to verification of the defect or malfunction upon delivery of this product to the Factory Service Center authorized by Customer Service.

If service is required, please call Customer Service at 1-800-288-2792 to obtain a Return Authorization Number and shipping instructions.

Disclaimer of Warranty

NOTE: This warranty is valid only if the product is used for the purpose for which it was designed. It does not cover (i) products which have been damaged by negligence or willful actions, misuse or accident, or which have been modified or repaired by unauthorized persons; (ii) cracked or broken cabinets, or units damaged by excessive heat; (iii) damage to digital media players, CD's or tape cassettes (if applicable); (iv) the cost of shipping this product to the Factory Service Center and its return to the owner.

This warranty is valid only in the United States of America and does not extend to owners of the product other than to the original purchaser. In no event will SDI or any of its affiliates, contractors, resellers, their officers, directors,

shareholders, members or agents be liable to you or any third party for any consequential or incidental damages, any lost profits, actual, exemplary or punitive damages. (Some states do not allow limitations on implied warranties or exclusion of consequential damages, so these restrictions may not apply to you.) This warranty gives you specific legal rights, and you may also have other rights which vary from state to state.

Your acknowledgment and agreement to fully and completely abide by the above mentioned disclaimer of warranty is contractually binding to you upon your transfer of currency (money order, cashier's check, or credit card) for purchase of your SDI product.

© 2016 SDI Technologies, Inc. All rights reserved
Questions? Visit www.ihome.com
or call 1-800-288-2792 Toll Free