

aquio

DOUBLE WALL INSULATED
STAINLESS STEEL BOTTLE
+ REMOVABLE WATERPROOF
BLUETOOTH SPEAKER

BC iBTB2

QUICK START GUIDE
CHARGE BEFORE USE

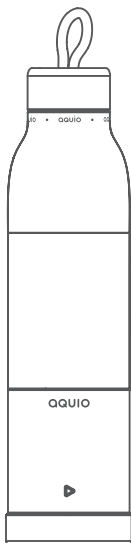

CONTROLS & INDICATORS

FRONT:



Play/Pause
Button

BACK:



Waterproof Cover



Reset Port
USB Charge Port

Battery LED
Indicator



Power
Button



Bluetooth
Button

Bluetooth LED
Indicator

GETTING STARTED

**CHARGE
SPEAKER
BEFORE USE**

Connect included USB cable to USB Charging Port (under waterproof cover) and to USB power source such as USB AC adapter connected to working outlet

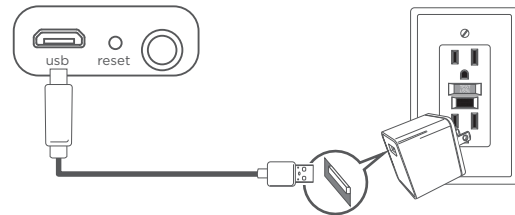

**Charge/Battery
Indicator:**



Green = charged



Red = charging

**Bluetooth
Indicator:**



Slow blink
= auto-link



Fast blink
= pairing



Solid
= paired

PAIRING BLUETOOTH

Pairing the First Time



Manual Pairing



- Make your Bluetooth device “discoverable”
- *Press and hold* the **Power Button** on back of speaker for 3 sec. to power ON.
- The first time the unit is powered on it will enter auto-pairing mode.
- Select “iHome iBTB2” on your device’s Bluetooth menu to complete pairing.
- To manually pair, power speaker ON. *Press and hold* **Bluetooth Button** for 2 seconds, then select “iHome iBTB2” on your device’s Bluetooth menu to complete pairing.

PLAYING BLUETOOTH AUDIO

- Press **Play/Pause Button** to play or pause Bluetooth audio.
- Press 2x to skip to next song
- Press 3x to skip to previous track OR start of current track
- *Press and hold* the **Power Button** for 3 sec. to power OFF.

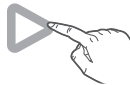

SPEAKERPHONE

- Speaker must be ON and paired to Bluetooth device to use speakerphone.
- Press **Play/Pause Button** to answer/end call
- *Press and hold* **Play/Pause Button** for 2 seconds to decline call

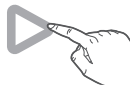

TIP: on some iOS (Apple) devices; you can view the iBTB2 battery status on your device’s screen. When device is paired and connected; look for a vertical battery icon next to the Bluetooth icon on the upper right corner of the device’s screen.

Bluetooth is a registered trademarks of Bluetooth SIG Inc.
Bluetooth technology is incorporated under license from Bluetooth SIG Inc.

HOW TO USE BOTTLE & SPEAKER

- Unscrew cap to fill bottle
- The Bottle and Speaker can be unscrewed to use separately
- Speaker is waterproof (keep cover closed near water)
- Screw the speaker base to bottom of bottle for best stability when using separately
- See Bottle Cautions for best experience

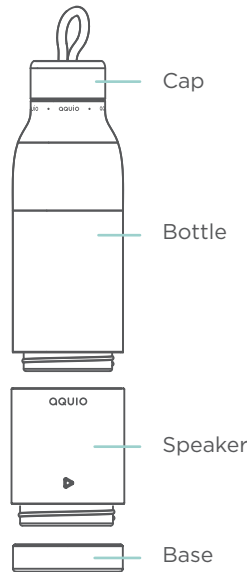

WATERPROOF OPERATION

- For proper waterproof operation, make sure the waterproof cover on the back of the unit is completely flush with the unit by pressing along the entire edge of the cover until it is completely and securely in place.



ready
for
water



not
ready for
water



IMPORTANT INFORMATION ABOUT WATERPROOF OPERATION

- The unit is IP67 waterproof rated, meaning it is immersible for up to 30 minutes at a depth of 1 meter (3 feet). It will typically withstand rain, snow and being submersed in shallow water. Longer duration or deeper immersion that exceeds the tested limits may cause product failure and void the warranty.
- DO NOT** immerse the unit in water for extended periods.
- DO NOT** immerse the unit in water deeper than 1 meter (about 3 feet).
- Make sure cover and surrounding surfaces are completely dry before opening cover to prevent moisture from damaging the internal electronics.
- Keep rubber cover free of dirt, sand, or other objects that can interfere with proper sealing. If for any reason the waterproof cover is not making a tight waterproof seal water may enter the unit.
- Rinse with tap water after immersion in salt water or swimming pool.
- DO NOT** clean unit with oily soaps or use chemicals or solvents. Clean with damp cloth.

BOTTLE CAUTIONS

- Wash with warm water, mild dish soap and rinse the bottle thoroughly prior to first use and after each use
- Remove bottle cap and thoroughly wash the removable silicone cap collar after each use
- Do not microwave or place in freezer
- Caution:** Hot beverages will remain hot for several hours
- DO NOT** overfill
- DO NOT** use with alcoholic or carbonated liquids that can cause pressure build up and potential lid failure
- Always be certain the lid is securely attached to bottle before using it

RESETTING UNIT

- If unit doesn't respond during use, insert the end of a paper clip or similar into the Reset Port located under the waterproof cover. Doing so will clear all previous settings (Bluetooth devices will need to be re-paired). Power unit on to resume normal operation.

Contact Us: 1•800• 288•2792



For warranty visit:
www.ihome.com/support

INTERNAL RECHARGEABLE LITHIUM-ION BATTERY

This device uses an internal non-replaceable rechargeable lithium-ion battery that should last the lifetime of the device. If you suspect your battery may be dead, try charging it for an extended period of time and try resetting the unit. If this fails, contact Customer Service at 1-800-288-2792.

WARNING/DISPOSAL OF UNIT

DO NOT attempt to change the battery. Doing so will void the warranty and could cause injury and damage to your device.

To dispose of the unit, follow the instructions below:

- Never dispose of used batteries/electronics with ordinary solid wastes, as they may contain harmful substances.
- Always dispose of used batteries/electronics in accordance with the prevailing community regulations.
- Many electronics retailers now recycle batteries and other electronic components at no charge.

GENERAL BATTERY PRECAUTIONS

- Never use or charge a battery if it appears to be leaking, discolored, deformed, or in any way abnormal.
- Never disassemble the unit or attempt to remove battery as that could cause leakage of alkaline solution or other electrolytic substances.
- Avoid charging a rechargeable battery when the temperature is not within 5°C - 35° C (41° - 95° Fahrenheit).
- Never expose a battery to any liquid.
- Never expose a battery to excessive heat such as direct sunlight or fire. Never use a battery pack in an unventilated vehicle where excessive internal temperatures may be encountered.
- Always keep batteries out of the reach of infants and small children.

FCC Information

FCC ID: EMOIBTB2
IC: 986B-IBTB2

FCC Radiation Exposure Statement

This equipment complies with FCC RF radiation exposure limits set forth for an uncontrolled environment.

This device complies with Part 15 of the FCC Rules, operation is subject to the following two conditions: (1) This device may not cause harmful interference, and (2) this device must accept any interference received, including interference that may cause undesired operation.

- Warning: Changes or modifications to this unit not expressly approved by the party responsible for compliance could void the user's authority to operate the equipment.
- NOTE: This equipment has been tested and found to comply with the limits for a Class B digital device, pursuant to Part 15 of the FCC Rules.

These limits are designed to provide reasonable protection against harmful interference in a residential installation. This equipment generates, uses and can radiate radio frequency energy and, if not installed and used in accordance with the instructions, may cause harmful interference to radio communications.

However, there is no guarantee that interference will not occur in a particular installation. If this equipment does cause harmful interference to radio or television reception, which can be determined by turning the equipment off and on, the user is encouraged to try to correct the interference by one or more of the following measures:

- Reorient or relocate the receiving antenna.
- Increase the separation between the equipment and receiver.
- Connect the equipment into an outlet on a circuit different from that to which the receiver is connected.
- Consult the dealer or an experienced radio/TV technician for help.

CAN ICES-3 (B)/NMB-3(B)

Canada Statement

This device complies with Industry Canada's licence-exempt RSSs. Operation is subject to the following two conditions:

- (1) This device may not cause interference; and
- (2) This device must accept any interference, including interference that may cause undesired operation of the device.

Le présent appareil est conforme aux CNR d'Industrie Canada applicables aux appareils radio exempts de licence. L'exploitation est autorisée aux deux conditions suivantes :

(1) l'appareil ne doit pas produire de brouillage;

(2) l'utilisateur de l'appareil doit accepter tout brouillage radioélectrique subi, même si le brouillage est susceptible d'en compromettre le fonctionnement.

The device meets the exemption from the routine evaluation limits in section 2.5 of RSS 102 and compliance with RSS-102 RF exposure, users can obtain Canadian information on RF exposure and compliance.

Le dispositif rencontre l'exemption des limites courantes d'évaluation dans la section 2.5 de RSS 102 et la conformité à l'exposition de RSS-102 rf, utilisateurs peut obtenir l'information canadienne sur l'exposition et la conformité de rf.

Contact Us: 1•800• 288•2792