

iHome®

Model: iBTW390 Bedside/Office Speaker System with Dual Charging



instruction manual

Questions? Contact Customer Service at 1-800-288-2792

What's Included:

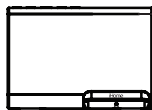

iBTW390



AC adapter

Meet Your iBTW390

Top

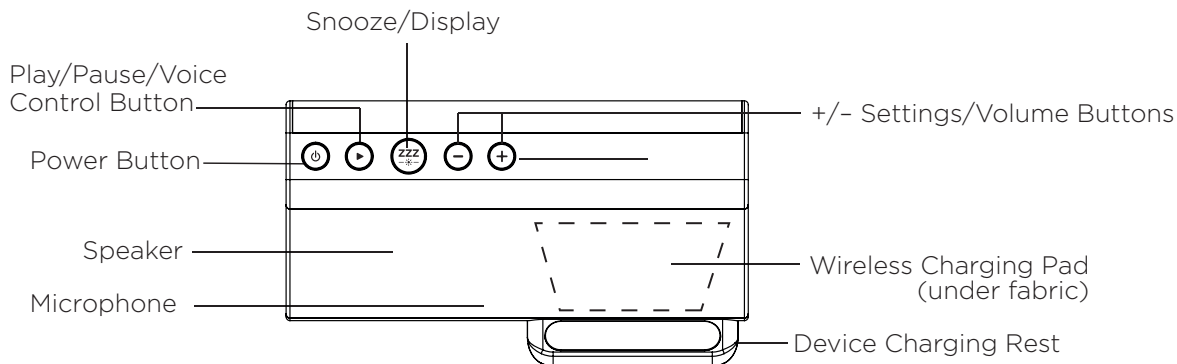

Back

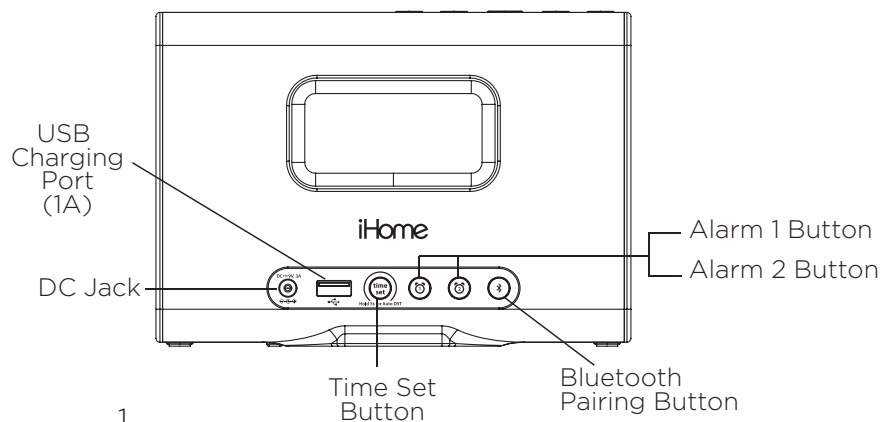
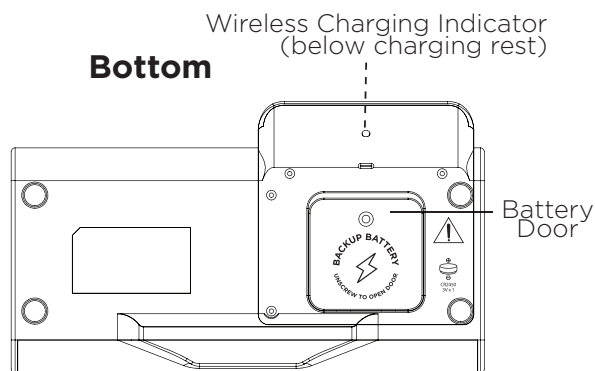

Quick Set-Up:

Step One Connecting the Unit

Connect the included AC adapter to the DC jack located on the back of the unit and connect the other end to a working wall outlet.

Step Two Bluetooth Pairing

- Turn on your Bluetooth device and make it 'discoverable' by turning on Bluetooth mode.
- Press the **Power Button** on the iBTW390. The first time the unit is powered on, it will automatically enter pairing mode.
- Select 'iHome iBTW390' on your device's Bluetooth menu to connect!

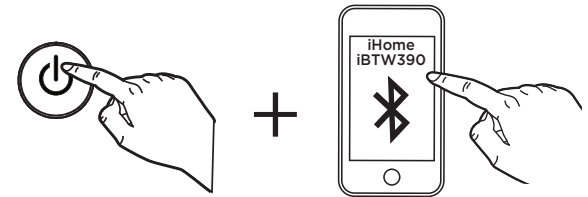
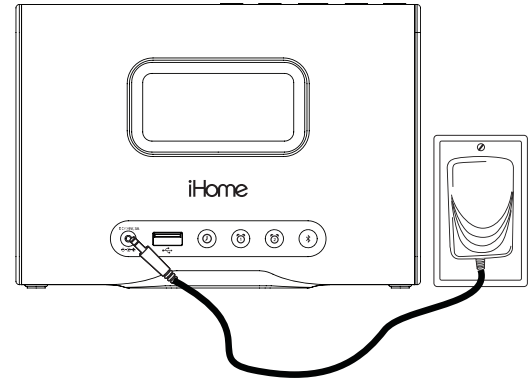

Step Three Setting Your Clock

- Press and hold the **Time Set Button** until the display flashes.
- Press the **-** or **+** **Buttons** to adjust selections and press **Time Set** to confirm.
- Do this for time, year, month and date.
- All done!



Automatic DST

This product can automatically change your clock in March and November for daylight savings time! To enable, hold the **Time Set Button** for a full 5 seconds. Press the **+/-** buttons to select DST ON/OFF.

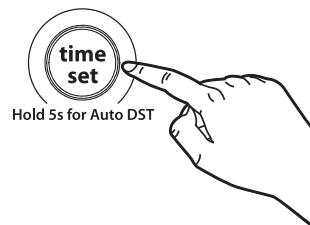

The Display

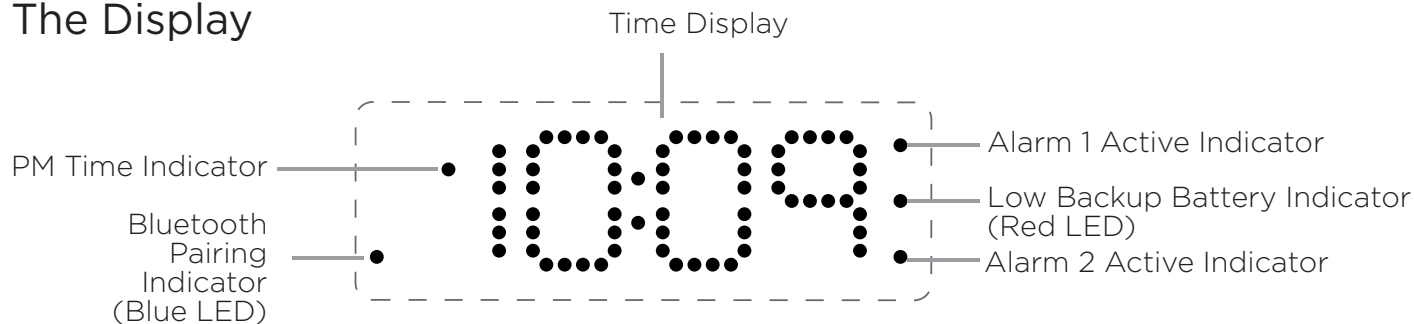

Charging Devices Via USB Port

1. Connect the standard size end of a USB cable (not included) to the USB port on the back of the unit and connect the other end to the charging port on your device.

2. Monitor the charging on your device. Some devices use a proprietary charging method and will not charge using the USB port. If this happens, you must charge your device using the charger that came with it.

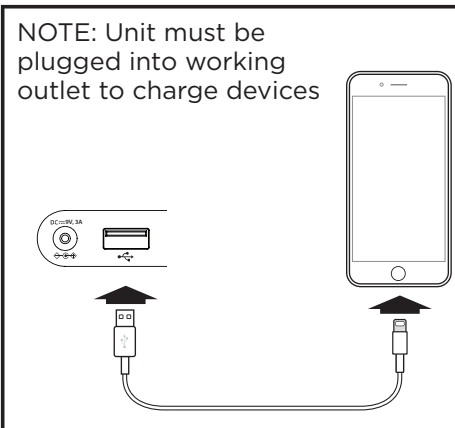

Setting the Clock

1. Press and hold the **⌚ Time Set Button** located on the back of the unit for 2 seconds until the clock display flashes and a beep sounds.
2. Press the **-** or **+** **Buttons** to adjust the clock to the current time (hold for rapid setting). Make sure you set the correct AM/PM time. The PM indicator appears to the left of the display; there is no AM indicator.
3. To toggle the clock display between standard 12 hour time and 24 hour (“military”) time display, press the **⌚ Alarm** or **⌚ Alarm Button** while the display is flashing during time setting.
4. Press **Time Set** to confirm the current time setting. The YEAR will flash on the display. Press the **-** or **+** **Buttons** to set the correct year.
5. Press **Time Set** to confirm the current year setting. The Month will flash on the display. Press the **-** or **+** **Buttons** to set the correct month (hold for rapid adjustment).
6. Press **Time Set** to confirm the current month setting. The Date will flash on the display. Press the **-** or **+** **Buttons** to set the correct date (hold for rapid adjustment).
7. Press **Time Set** to confirm the date. 2 beeps will confirm time setting is complete.

Setting and Using the Alarm

This unit features dual alarms which can be set to different times and alarm sources. Each is set in the same way. Instructions are given as “Alarm Button”; use **⌚ Alarm Button** or **⌚ Alarm Button** located on the back of the unit to set respective alarms. **Note:** Each step must be completed while display is flashing or the step will time-out in 10 seconds without any changes saved.

1. Press and hold the **Alarm Button** for 2 seconds until the alarm time display and alarm icon flash. A beep sounds.
2. Press the **-** or **+** **Buttons** to adjust the alarm time to the desired time (hold for rapid setting). Make sure you set the correct AM/PM alarm time. The PM indicator appears to the left of the time display; there is no AM indicator.
3. Press the **Alarm Button** to confirm the alarm time setting. The wake-to schedule will flash. Press the **-** or **+** **Buttons** to set the desired alarm schedule: 7 Days (every day), 5 Days (week days only) or 2 Days (weekends only).
4. Press the **Alarm Button** to confirm the alarm schedule. The wake source indicator will flash on the display. Press the **-** or **+** **Buttons** to select the wake to alarm source: “bt” (Bluetooth) or tone. (Continued on next page...)

- Wake to Bluetooth:** You will wake to the currently linked Bluetooth device. If no device is detected, the alarm will default to current Tone.
- Wake to Tone:** Press the **Alarm Button** to confirm. Press the **-** or **+** **Buttons** as needed to listen to and to select one of the four built-in wake-to tones (t1 - t4).

5. Press the **Alarm Button** to confirm the alarm source. The volume display will flash.
6. Press the **-** or **+** **Buttons** to adjust the alarm volume. Note that the alarm volume setting is stored separately from other volume settings.
7. Press the **Alarm Button** to confirm the alarm settings and exit alarm setting mode. 2 beeps will confirm alarm setting is complete. The alarm icon on the display will indicate the alarm is armed.

Previewing the Alarm and Turning the Alarm On/Off

1. Press and release the **Alarm Button** to view the current alarm time.
2. Press and release the **Alarm Button** as needed to toggle the alarm ON and OFF, indicated by the related white alarm indicator and a beep.
3. When the alarm sounds, press the **Power Button** or corresponding **Alarm Button (1 or 2)** to disable the alarm and reset it to come on at the same time the next day.

Snooze/Display Dimmer (ZZZ Button)

1. To program Snooze, press and hold the **Snooze/Display Dimmer** during normal operation (when no alarm is sounding).
2. Press the **-** or **+** **Buttons** to select the desired snooze time (between 01 and 29 minutes).
3. Press the **Snooze/Display Dimmer Button** to confirm Snooze setting. 2 beeps will sound.
4. While the alarm is sounding, press and release the **Snooze/Display Dimmer Button** to temporarily silence the alarm for the set duration (9 minutes is the default). Snooze can be used several times during the 1 hour alarm sounding time.
5. To adjust the brightness of the display, press and release the **Snooze/Display Dimmer Button** during normal operation (when no alarm is sounding) to cycle through the brightness display settings (Hi, 3, 2, Lo, and Off).

Using Qi Wireless Charging

This unit will wirelessly charge Qi compatible wireless charging phones. Place Qi compatible device face up on charging rest as shown.

Check the Wireless Charging Indicator on the iBTW390 for charging status:

LED glows solid amber for 10 seconds: Device is charging properly.

Solid green LED: Device is charged.

Rapid blinking amber LED: Device is not charging properly. Reposition device.

Note: The solid green LED may not glow when iOS devices are fully charged.

CAUTION: Remove metal protective or magnetic case from phone before charging. When charging phone, do not place magnetic-striped or other metal objects on the charger. Doing so could damage the object or this unit. Qi compatible phones with metallic looking finishes will charge normally.

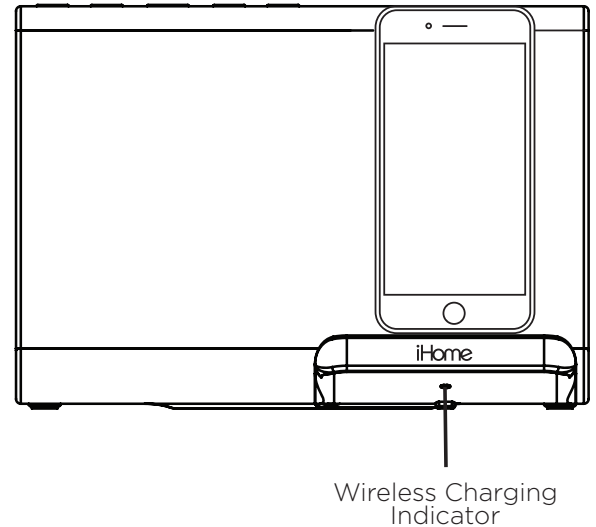

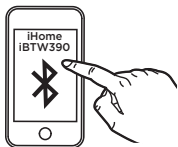

Pairing Your Bluetooth Device

Pairing establishes a unique communication connection between your Bluetooth device and the speaker. Once paired, you will be able to stream audio wirelessly to the iBTW390. When AC power is connected, and the **⏻ Button** OR or **🔗 Bluetooth Button** is pressed, the iBTW390 will attempt to autolink to a previously paired device.





1. Turn on your Bluetooth device and make it “discoverable” by turning on Bluetooth mode (check in Connections or Settings).
2. Press the **⏻ Button** to turn on the iBTW390. **The first time the unit is powered on it will enter pairing mode automatically.** After this, you will need to pair using the Bluetooth Button after powering on (see step 3 below).
3. *Press and hold* the **🔗 Bluetooth Button** on back of the iBTW390 for 2 seconds. “PAIR” will appear on the display and the Bluetooth indicator will flash blue, a voice prompt will announce “PAIRING”, indicating the iBTW390 is in pairing mode.
4. Select “iHome iBTW390” in your device’s Bluetooth menu to connect device. If prompted for a passcode, enter “1234” on your device’s keypad.
5. If pairing is successful, a voice prompt will announce “CONNECTED”, then Bluetooth indicator appears solid blue, indicating the iBTW390 is ready to play music. There should also be an indication on your device. If no device is successfully paired within 3 minutes the iBTW390 will default to previous mode. Once the iBTW390 is paired to a device, it will attempt to autolink when the device is within range (about 33 feet). To reset Bluetooth, press and hold the **Bluetooth Button** for 10 seconds.

Playing Audio Via Bluetooth

1. “bt” and the  Bluetooth indicator appear on the display when the unit is on and your device is connected. Press the  **Button** on the unit to play or pause audio from your linked Bluetooth device.
2. Press the **-** or **+** **Buttons** to adjust the volume on the unit.
3. When done listening, press the  **Button** to turn the unit off.

Using the Speakerphone feature

NOTE: The unit must be powered on and linked to a Bluetooth phone to receive a call.

1. When a call is received, playing music is muted to hear the ring tone. “Call” will flash on the display. Press the  **Button** to answer the call; *press and hold* the  **Button** to ignore the call.
2. Press the  **Button** to end the call and resume previous function.

Using the Voice Control feature

NOTE: The unit must be powered on and linked to an iOS or Android Bluetooth device to use Voice Control. *Press and hold* the  **Button** for 2 seconds. ‘CALL’ will appear on the display. Wait for a beep to activate voice control with Siri or Google Assistant.

Voice control requires an active internet connection on connected Bluetooth device with iOS 10 and Android 5.0 and later. When activated, the speaker microphone acts as an extension of the microphone in your smartphone to make/take calls, enable you to ask Siri®/Google Assistant™ to play music and more.

Replacing and Installing Clock Backup Battery

The unit comes with 1 CR2450 back-up battery installed to provide continuous alarm operation and clock settings in the event of a power failure. **Remove the battery pull tab before use.** When the Battery Low Red LED located in the middle of the display is flashing, it is time to replace the back-up battery. The battery compartment is located on the bottom of the unit.

1. Please make sure the AC adaptor is connected, otherwise all settings may be lost during battery replacement.
2. Use a Phillips screwdriver to remove the battery compartment cover located on the bottom of the unit.
3. Remove exhausted battery. Insert 1 CR2450 battery checking that the + side is facing you. Replace the compartment door. Do not over tighten.

Note: Make sure you dispose of battery properly (see your local regulations).

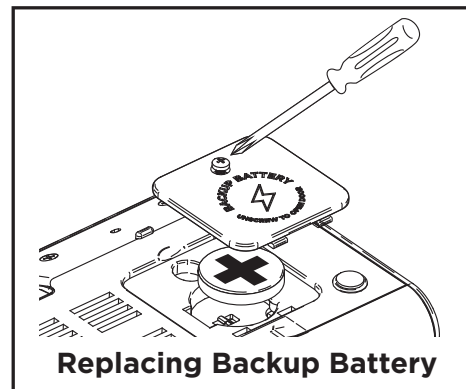

WARNING: Lithium batteries can explode or cause burns if disassembled, shorted, recharged, exposed to water, fire, or high temperatures. Do not place loose batteries in a pocket, purse, or other container containing metal objects, mix with used or other battery types, or store with hazardous or combustible materials. Store in cool, dry, ventilated area. Follow applicable laws and regulations for transport and disposal.



- Do not ingest the battery, Chemical Burn Hazard. This product contains a coin/button cell battery. If the coin/button cell battery is swallowed, it can cause severe internal burns in just 2 hours and can lead to death.
- Keep new and used batteries away from children. If the battery compartment does not close securely, stop using the product and keep it away from children. If you think batteries might have been swallowed or placed inside any part of the body, seek immediate medical attention.

Troubleshooting

Unit doesn't respond (no sound)

- Check that all connections are correct and properly plugged in.
- Make sure your device is properly paired with the iBTW390.
- Make sure the Power is ON.
- Make sure unit is not connected to an outlet controlled by a switch.
- Make sure volume is up on your Bluetooth device and on unit.

Unit doesn't respond (locked up or frozen)

- The unit may need to be reset. To do so, unplug the unit from power source and remove the backup battery. Let unit stand for 2 minutes. Re-install backup battery and connect unit to power source. You will need to reset the clock, Bluetooth and any other settings.

Trouble pairing device/computer with iBTW390

Bluetooth implementation varies depending on your device's hardware and operating system.

- When you power ON the unit, it will automatically link with the last previously paired Bluetooth device if the device is still within range (about 33 feet).
- Make sure your device is working properly. Check your device's manual for Bluetooth pairing details.
- To clear all Bluetooth devices, *press and hold the **Bluetooth Button** for 10 seconds* when unit is not in pairing mode. A tone will sound.

Maintenance

- Place the unit on a level surface away from sources of direct sunlight or excessive heat.
- Protect your furniture when placing your unit on a natural wood and lacquered finish. A cloth or other protective material should be placed between it and the furniture.
- Clean your unit with a soft cloth moistened only with mild soap and water. Stronger cleaning agents, such as benzene, thinner or similar materials can damage the surface of the unit.

IMPORTANT SAFETY INSTRUCTIONS

When used in the directed manner, this unit has been designed and manufactured to ensure your personal safety. However, improper use can result in potential electrical shock or fire hazards. Please read and follow all safety and operating instructions carefully before installation and use, and keep these instructions handy for future reference. Take special note of all warnings listed in these instructions and on the unit.

1. **Water and Moisture** – The unit should not be used near water. For example: near a bathtub, washbowl, kitchen sink, laundry tub, swimming pool or in a wet basement.
2. **Ventilation** – The unit should be situated so that its location or position does not interfere with its proper ventilation. For example, it should not be situated on a bed, sofa, rug or similar surface that may block ventilation openings. Also, it should not be placed in a built-in installation, such as a bookcase or cabinet, which may impede the flow of air through the ventilation openings.
3. **Heat** – The unit should be situated away from heat sources such as radiators, heat registers, stoves or other appliances (including amplifiers) that produce heat.
4. **Power Sources** – The unit should be connected to a power supply only of the type described in the operating instructions or as marked on the appliance. Only use the AC adapter that came with the unit.
5. **Power-Cable Protection** – Power supply cables should be routed so that they are not likely to be walked on or pinched by items placed upon or against them. It is always best to have a clear area from where the cable exits the unit to where it is plugged into an AC socket.
6. **Cleaning** – The unit should be cleaned only as recommended. See the Maintenance section for cleaning instructions.
7. **Objects and Liquid Entry** – Care should be taken so that objects do not fall and liquids are not spilled into any openings or vents located on the product.
8. **Attachments** – Do not use attachments not recommended by the product manufacturer.
9. **Lightning and Power Surge Protection** – Unplug the unit from the wall socket and disconnect the antenna or cable system during a lightning storm or when it is left unattended and unused for long periods of time. This will prevent damage to the product due to lightning and power-line surges.
10. **Overloading** – Do not overload wall sockets, extension cords, or integral convenience receptacles as this can result in a risk of fire or electric shock.
11. **Damage Requiring Service** – The unit should be serviced by qualified service personnel when:
 - A. the power supply cable or plug has been damaged.
 - B. objects have fallen into or liquid has been spilled into the enclosure.
 - C. the unit has been exposed to rain.
 - D. the unit has been dropped or the enclosure damaged.
 - E. the unit exhibits a marked change in performance or does not operate normally.
12. **Periods of Nonuse** – If the unit is to be left unused for an extended period of time, such as a month or longer, remove batteries before storage.

IMPORTANT SAFETY INSTRUCTIONS (CONTINUED)

13. Servicing – The user should not attempt to service the unit beyond those methods described in the user manual. Service methods not covered in the operating instructions should be referred to qualified service personnel.
14. Magnetic Interference: This product's speakers contain powerful magnets which could cause interference or damage to sensitive equipment such as hard drives, CRT televisions and monitors, as well as medical, scientific, and navigational devices. Keep this unit away from these products at all times.
15. Only use attachments/accessories specified by the manufacturer. This product is suitable for use in tropical and/or moderate climates.
16. The unit should be serviced by qualified service personnel when the enclosure damaged or does not operate normally.
17. Attention should be drawn to the environmental aspects of battery disposal.
18. No naked flame sources, such as lighted candles, should be placed on this product.
19. This product is suitable for use in tropical and/or moderate climates.
20. WARNING: To reduce the risk of fire or electric shock, do not expose this product to rain or moisture
21. The mains plug of power adaptor is used as the disconnect device, it shall remain readily operable.

FCC Information

iBTW390

FCC Radiation Exposure Statement

FCC ID:

This equipment complies with FCC RF radiation exposure limits set forth for an uncontrolled environment.

IC:

This device complies with Part 15 of the FCC Rules, operation is subject to the following two conditions: (1) This device may not cause harmful interference, and (2) this device must accept any interference received, including interference that may cause undesired operation.

- Warning: Changes or modifications to this unit not expressly approved by the party responsible for compliance could void the user's authority to operate the equipment.
- NOTE: This equipment has been tested and found to comply with the limits for a Class B digital device, pursuant to Part 15 of the FCC Rules.

These limits are designed to provide reasonable protection against harmful interference in a residential installation. This equipment generates, uses and can radiate radio frequency energy and, if not installed and used in accordance with the instructions, may cause harmful interference to radio communications.

However, there is no guarantee that interference will not occur in a particular installation. If this equipment does cause harmful interference to radio or television reception, which can be determined by turning the equipment off and on, the user is encouraged to try to correct the interference by one or more of the following measures:

- Reorient or relocate the receiving antenna.
- Increase the separation between the equipment and receiver.
- Connect the equipment into an outlet on a circuit different from that to which the receiver is connected.
- Consult the dealer or an experienced radio/TV technician for help.

CAN ICES-3(B) / NMB-3(B)

CAN RSS-216/CNR-216

IC Statement

This device complies with Industry Canada license-exempt RSS standard(s). Operation is subject to the following two conditions: (1) this device may not cause interference, and (2) this device must accept any interference, including interference that may cause undesired operation of the device.

Le présent appareil est conforme aux CNR d'Industrie Canada applicables aux appareils radio exempts de licence. L'exploitation est autorisée aux deux conditions suivantes : (1) l'appareil ne doit pas produire de brouillage, et (2) l'utilisateur de l'appareil doit accepter tout brouillage radioélectrique subi, même si le brouillage est susceptible d'en compromettre le fonctionnement.

The device meets the exemption from the routine evaluation limits in section 2.5 of RSS 102 and compliance with RSS-102 RF exposure, users can obtain Canadian information on RF exposure and compliance.

Le dispositif rencontre l'exemption des limites courantes d'évaluation dans la section 2.5 de RSS 102 et la conformité à l'exposition de RSS-102 rf, utilisateurs peut obtenir l'information canadienne sur l'exposition et la conformité de rf.

Limited One Year Warranty

iHome Products, a division of SDI Technologies Inc. (hereafter referred to as SDI), warrants this product to be free from defects in workmanship and materials, under normal use and conditions, for a period of one (1) year from the date of original purchase. Should this product fail to function in a satisfactory manner, it is best to first return it to the store where it was originally purchased. Should this fail to resolve the matter and service still be required by reason of any defect or malfunction during the warranty period, SDI will repair or, at its discretion, replace this product without charge. This decision is subject to verification of the defect or malfunction upon delivery of this product to the Factory Service Center authorized by Customer Service.

If service is required, please call Customer Service at 1-800-288-2792 to obtain a Return Authorization Number and shipping instructions. A copy of the sales receipt is required to validate in-warranty coverage.

Disclaimer of Warranty

NOTE: This warranty is valid only if the product is used for the purpose for which it was designed. It does not cover (i) products which have been damaged by negligence or willful actions, misuse or accident, or which have been modified or repaired by unauthorized persons; (ii) cracked or broken cabinets, or units damaged by excessive heat; (iii) damage to digital media players, CD's or tape cassettes (if applicable); (iv) the cost of shipping this product to the Factory Service Center and its return to the owner.

This warranty is valid only in the United States of America and does not extend to owners of the product other than to the original purchaser. In no event will SDI or any of its affiliates, contractors, resellers, their officers, directors, shareholders, members or agents be liable to you or any third party for any consequential or incidental damages, any lost profits, actual, exemplary or punitive damages. (Some states do not allow limitations on implied warranties or exclusion of consequential damages, so these restrictions may not apply to you.) This warranty gives you specific legal rights, and you may also have other rights which vary from state to state. Your acknowledgment and agreement to fully and completely abide by the above mentioned disclaimer of warranty is contractually binding to you upon your transfer of currency (money order, cashier's check, or credit card) for purchase of your SDI product.

© 2019 SDI Technologies, Inc. All rights reserved
Questions? Visit www.ihome.com
or call 1-800-288-2792 Toll Free