

## Maintenance

- Place the unit on a level surface away from sources of direct sunlight or excessive heat.
- Protect your furniture when placing your unit on a natural wood and lacquered finish. A cloth or other protective material should be placed between it and the furniture.
- Clean your unit with a soft cloth moistened only with mild soap and water. Stronger cleaning agents, such as Benzene, thinner or similar materials can damage the surface of the unit.

## A Consumer Guide To Product Safety

### IMPORTANT SAFETY INSTRUCTIONS

When used in the directed manner, this unit has been designed and manufactured to ensure your personal safety. However, improper use can result in potential electrical shock or fire hazards. Please read all safety and operating instructions carefully before installation and use, and keep these instructions handy for future reference. Take special note of all warnings listed in these instructions and on the unit.

1. **Water and Moisture** – The unit should not be used near water. For example: near a bathtub, washbowl, kitchen sink, laundry tub, swimming pool or in a wet basement.
2. **Heat** – The unit should be situated away from heat sources such as radiators, heat registers, stoves or other appliances (including amplifiers) that produce heat.
3. **Cleaning** – The unit should be cleaned only as recommended. See the Maintenance section of this manual for cleaning instructions.
4. **Objects and Liquid Entry** – Care should be taken so that objects do not fall and liquids are not spilled into any openings or vents located on the product.
5. **Attachments** – Do not use attachments not recommended by the product manufacturer.
6. **Damage Requiring Service** – The unit should be serviced by qualified service personnel when:
  - A. the power supply cable or plug has been damaged.
  - B. objects have fallen into or liquid has been spilled into the enclosure.
  - C. the unit has been exposed to rain.
  - D. the unit has been dropped or the enclosure damaged.
  - E. the unit exhibits a marked change in performance or does not operate normally.
7. **Servicing** – The user should not attempt to service the unit beyond those methods described in the user's operating instructions. Service methods not covered in the operating instructions should be referred to qualified service personnel.

Questions? Visit [www.ihomeaudio.com](http://www.ihomeaudio.com)  
or call 1-800-288-2792 Toll Free

## Limited 90-Day Warranty Information

iHome Products, a division of SDI Technologies Inc. (hereafter referred to as SDI Technologies), warrants this product to be free from defects in workmanship and materials, under normal use and conditions, for a period of 90 days from the date of original purchase.

Should this product fail to function in a satisfactory manner, it is best to first return it to the store where it was originally purchased. Should this fail to resolve the matter and service still be required by reason of any defect or malfunction during the warranty period, SDI Technologies will repair or, at its discretion, replace this product without charge (except for a \$20.00 charge for handling, packing, return UPS/postage, and insurance). This decision is subject to verification of the defect or malfunction upon delivery of this product to the Factory Service Center listed below. The product must include proof of purchase, including date of purchase. The fee for service without proof of purchase is \$40.00.

Before returning this product for service, please first replace the batteries (if applicable) with fresh ones, as exhausted or defective batteries are the most common cause of problems encountered.

If service is still required:

1. Remove the batteries (if applicable) and pack the unit in a well padded, heavy corrugated box.
2. Enclose a photocopy of your sales receipt, credit card statement, or other proof of the date of purchase, if within the warranty period.
3. Enclose a check or money order payable to the order of SDI Technologies, for the sum of \$20.00 (\$40.00 without proof of purchase).
4. Send the unit prepaid and insured, to the Factory Service Center listed below.

#### Consumer Repair Department

SDI Technologies Inc.  
1330 Goodyear Drive  
El Paso, TX 79936-6420

#### Disclaimer of Warranty

**NOTE:** This warranty is valid only if the product is used for the purpose for which it was designed. It does not cover (i) products which have been damaged by negligence or willful actions, misuse or accident, or which have been modified or repaired by unauthorized persons; (ii) cracked or broken cabinets, or units damaged by excessive heat; (iii) damage to digital media players, CD's or tape cassettes (if applicable); (iv) the cost of shipping this product to the Factory Service Center and its return to the owner.

This warranty is valid only in the United States of America and does not extend to owners of the product other than to the original purchaser. In no event will SDI Technologies or any of its affiliates, contractors, resellers, their officers, directors, shareholders, members or agents be liable to you or any third party for any consequential or incidental damages, any lost profits, actual, exemplary or punitive damages. (Some states do not allow limitations on implied warranties or exclusion of consequential damages, so these restrictions may not apply to you.) This warranty gives you specific legal rights, and you may also have other rights which vary from state to state.

Your acknowledgement and agreement to fully and completely abide by the above mentioned disclaimer of warranty is contractually binding to you upon your transfer of currency (money order, cashier's check, or credit card) for purchase of your SDI Technologies product.

© 2010 SDI Technologies, Inc. All rights reserved.  
iHome is a registered trademark of SDI Technologies, Inc.  
iPad is a trademark of Apple, Inc.

 Trademark of New Transducers Ltd

# iHome®

Model iDM70

iPad™ Case with Rechargeable  
Stereo Speakers



Questions?  
Visit [www.ihomeaudio.com](http://www.ihomeaudio.com)

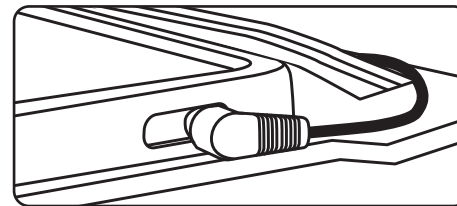
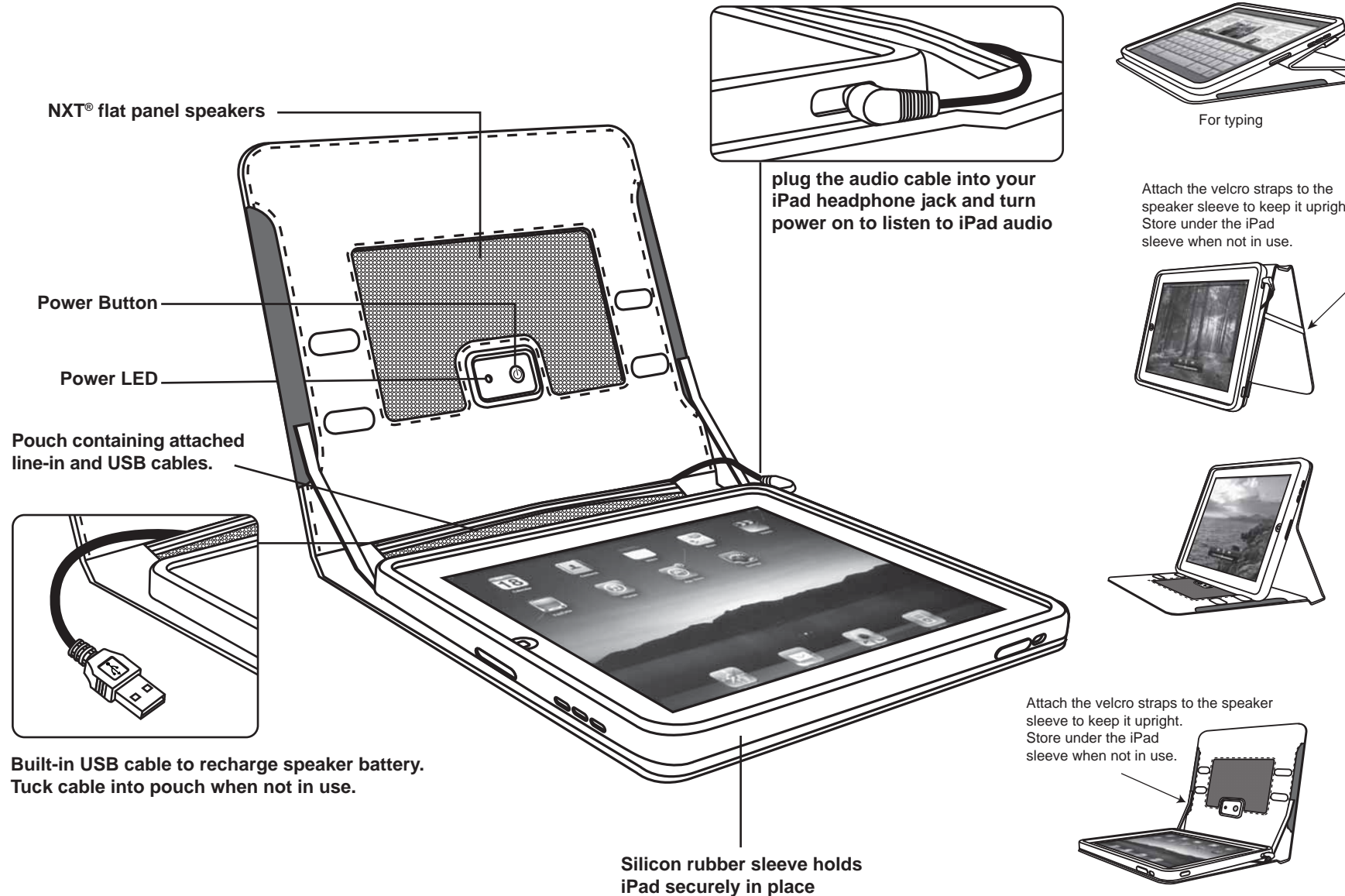

plug the audio cable into your iPad headphone jack and turn power on to listen to iPad audio



For typing

Attach the velcro straps to the speaker sleeve to keep it upright. Store under the iPad sleeve when not in use.



Attach the velcro straps to the speaker sleeve to keep it upright. Store under the iPad sleeve when not in use.

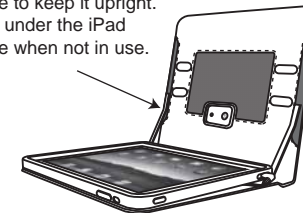

Versatile multi-position stand

## Internal Rechargeable Lithium-ion Battery

This device uses an internal rechargeable lithium-ion battery that should last the lifetime of the device. If you suspect your battery may be dead, try charging it several times. If the battery does not recharge, please contact us for repair information. Please do NOT attempt to change the battery yourself. If the battery has died and you do not want us to replace your battery, you should follow the disposal instructions below.

### WARNING/DISPOSAL OF UNIT

- Never dispose of used batteries/electronics with ordinary solid wastes, since they contain toxic substances.
- Always dispose of used batteries/electronics in accordance with the prevailing community regulations that apply to the disposal of batteries/electronics. If there are no local regulations concerning battery/electronics disposal, please dispose of the device in a waste bin for electronic devices.
- Many electronics retailers now recycle batteries and other electronic components at no charge. Check to see which ones in your area do so.

### CAUTION

- Never use or charge the battery if it appears to be leaking, discolored, deformed, or in any way abnormal.
- Never disassemble the unit or attempt to remove battery as that could cause leakage of alkaline solution or other electrolytic substance.
- Always confirm that the temperature is 5°C – 35° C (41° - 95° Fahrenheit) before you charge the battery. Leakage or deterioration of the battery may occur if this warning is not heeded.
- Never expose the battery to any liquid.
- Never expose the battery to excessive heat such as direct sunlight or fire. Never use the battery pack in an unventilated vehicle where excessive internal temperatures may be encountered.
- Always keep the battery out of the reach of infants and small children.

## Using the iDM70

The iDM70 is a durable protective iPad case with built-in NXT® flat panel speakers powered by an internal re-chargable lithium-ion battery.

### • To place iPad in case:

1. Slide off elastic closure band on iDM70.
2. Gently place your iPad into the silicon rubber sleeve, making sure to align the openings with the various matching iPad access points. *Hint:* there is a dimple in the sleeve that should line up just below the home button.

**NOTE:** The silicon rubber sleeve is attached to the case. DO NOT TRY TO REMOVE THE SLEEVE.

### • To charge the iDM70:

1. Plug the built-in USB cable into a powered USB port on your computer or iHome charging station. During charging, the power LED will change to red. Once charged, the light will turn off. Please allow at least 3 hours to fully charge the unit. At moderate listening volume, a charge should last over 6 hours. When the the sound becomes weak or distorted, it's time to recharge the battery.

### • To listen to the iDM70:

1. Plug the iDM70's 3.5mm audio plug into your iPad's headphone jack.
2. Press the **Power button** on the unit. The Power LED will turn green.
3. Position the case as desired for typing, watching movies, or listening to music. Use the velcro straps as needed to keep stand in position.
4. Adjust the volume on your iPad to control loudness. If you experience distortion, turn down the volume.

5. To turn off the unit, press the **Power button**. The Power LED will go off.

**NOTE:** You can listen to the iDM70 while charging it. The Power LED will turn orange when listening to music while the unit is charging. Once fully charged the LED will turn green.