

iHome®

Model iP15
**LED Color Changing
Stereo System to Charge
and Play Your iPhone / iPod**

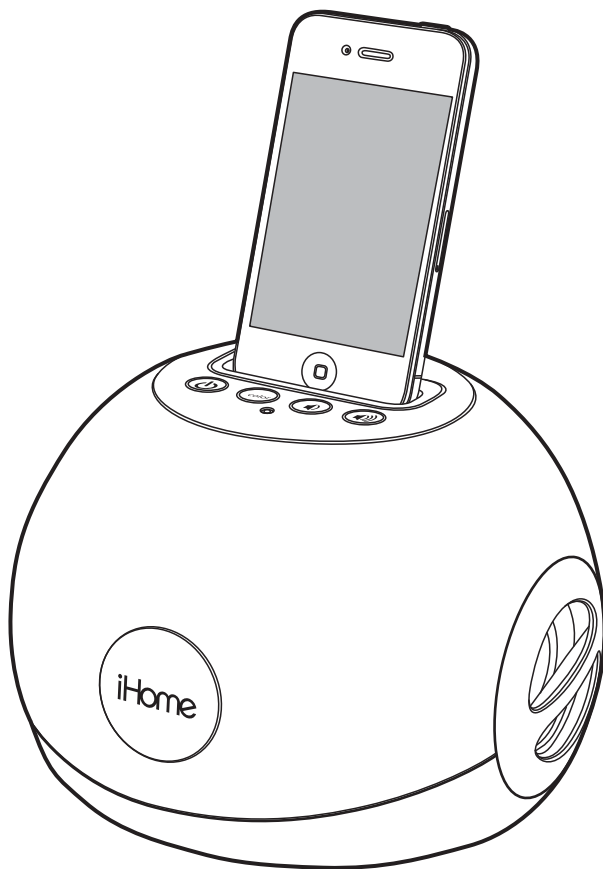

Questions? Visit www.ihomeintl.com

Table of Contents

Controls and indicators -----	1
Quick Start -----	2
Maintenance -----	2
Playing and Charging iPhone/iPod -----	3
Color Change mode -----	3
Using the Line-in Jack -----	3
A Consumer Guide to Product Safety -----	4
Trouble Shooting -----	5



This product bears the selective sorting symbol for waste electrical and electronic equipment (WEEE).

This means that this product must be handled pursuant to European Directive 2002/96/EC in order to be recycled or dismantled to minimize its impact on the environment.

For further information, please contact your local or regional authorities.



Electronic products not included in the selective sorting process are potentially dangerous for the environment and human health due to the presence of hazardous substances.

Getting Started

Thank you for purchasing the iHome iP15 Color Change Speaker System for your iPhone or iPod. Designed specifically to work with your iPhone or iPod, this system provides high quality audio performance combined with relaxing colored mood lights. Please read this instruction carefully before operating the unit and keep it for future reference.

Install iPhone/iPod Insert

Your iP15 comes with 5 removable inserts for popular iPod and iPhone models to ensure your iPhone/iPod fits properly in the Dock (please see the table in Quick Start Section). If there is no insert for your particular iPhone or iPod model, you can still dock your iPhone or iPod safely provided you always dock and remove it from the dock gently and carefully.

Connect Power

Plug the AC adaptor cable into the AC Adaptor Jack on the back of the unit and the other end into a standard 120V wall outlet.

Controls and Indicators

Top panel

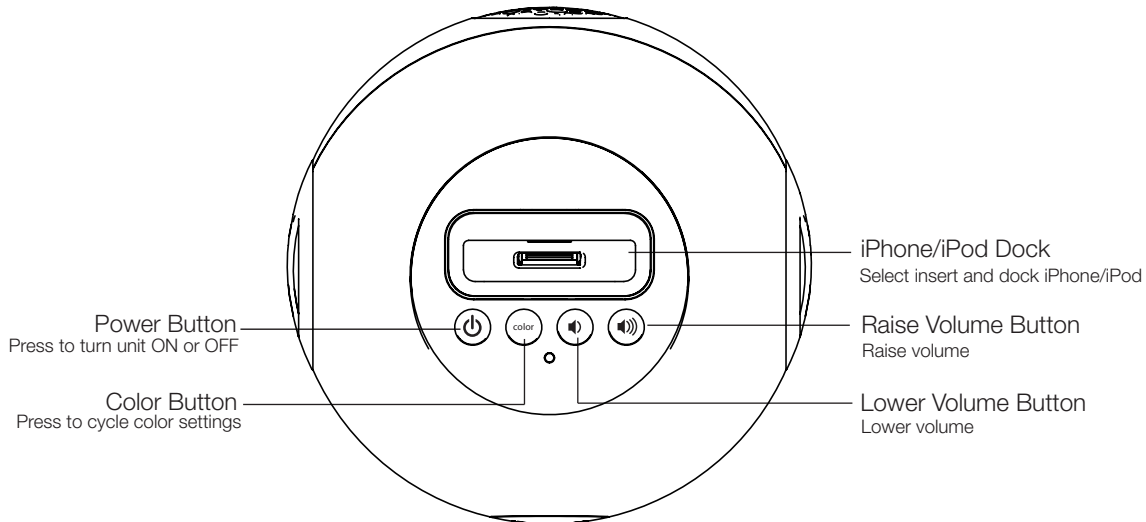

Back panel

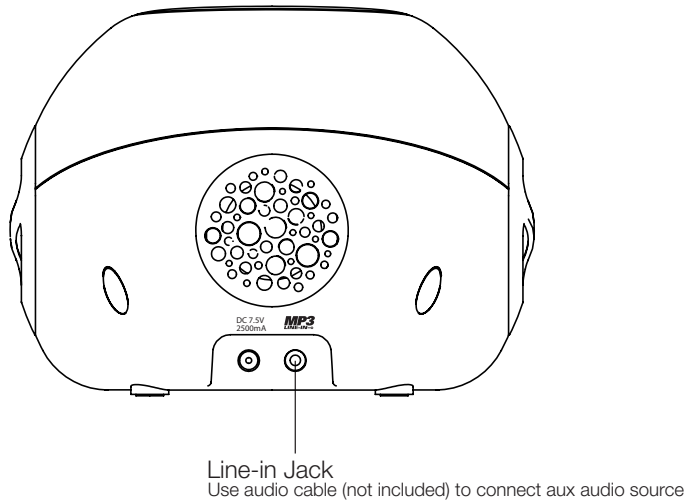

iP15 Quick Start

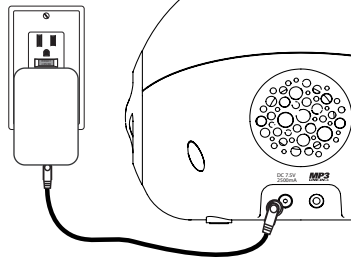

Attach AC adaptor cable to jack on back of the iP15 and plug the other end into a wall socket to play and charge iPhone/iPod.

2: inserts

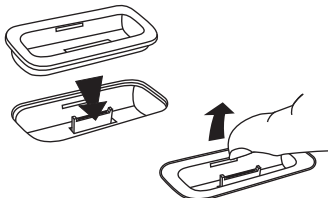

Select the dock insert for your iPhone/iPod model from the table below and place insert in dock. To remove insert, place thumbnail in slot and gently pull upwards.

3: iPhone/iPod

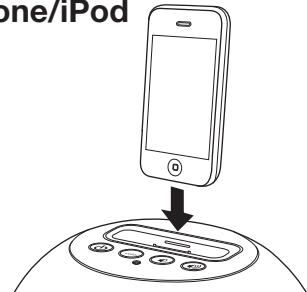

Insert playing iPhone/iPod into the dock (must not be in a "skin" or case). iPhone/iPod will charge while docked. Press the **Power Button** on the iP15 to listen to your iPhone/iPod.

Use this insert	iPhone 3G insert 15	iPod touch 2G insert 16	nano 5G insert 18	iPhone 4 insert 19	nano 6G/touch 4G insert 20
For this iPhone / iPod	iPhone 3G/3GS	iPod touch 2G/3G	nano 5G	iPhone 4	nano 6G/ iPod touch 4G

Maintenance

- Place the unit on a level surface away from sources of direct sunlight or excessive heat.
- Protect your furniture when placing your unit on a natural wood and lacquered finish. A cloth or other protective material should be placed between it and the furniture.
- Clean your unit with a soft cloth moistened only with mild soap and water. Stronger cleaning agents, such as Benzene, thinner or similar materials can damage the surface of the unit.

Playing and Charging your iPhone/iPod

1. Place proper insert for your iPhone or iPod (see insert table on Quick Start Section) in Dock, then gently dock playing iPhone or iPod. The unit will turn on and you will hear your music. When docked, iPhone or iPod will charge until fully charged. The iPhone or iPod will not overcharge.
2. If iPhone or iPod is not in play mode, press the **⏻ Button** on the iP15 to play your iPhone or iPod. The power on indicator will light up to show the iP15 is on.
3. Press the **⏮ or ⏭ Button** Volume to adjust the volume.
4. To switch off the unit, press the **⏻ Button** again.

Color Change Mode

There are 5 color settings. Press the **Color Button** to cycle through them. The settings are: slow color change (default), fixed color (press the **Color Button** when the desired color is showing to select that color), pulse to music, fast color change and light off.

Using the Line-in Jack

1. Plug one end of an audio patch cord (**available at www.ihome.com**) into the headphone or line-out jack on your audio device and the other end of the patch cord into the iP15 Line-in Jack located on the back of the unit.
2. Press the **⏻ Button** on the iP15 to play your audio device. The power on indicator will light up to show the iP15 is on. Place your device in play mode.
3. Press the **⏮ or ⏭ Button** to adjust the volume.
4. To switch off the unit press the **⏻ Button** again. Remember to turn off your audio device, too.

NOTE: DO NOT play a line-in device while iPhone/iPod is playing or you will hear both audio sources at once.

IMPORTANT SAFETY INSTRUCTIONS

When used in the directed manner, this unit has been designed and manufactured to ensure your personal safety. However, improper use can result in potential electrical shock or fire hazards. Please read all safety and operating instructions carefully before installation and use, and keep these instructions handy for future reference. Take special note of all warnings listed in these instructions and on the unit.

1. **Water and Moisture** – The unit should not be used near water. For example: near a bathtub, washbowl, kitchen sink, laundry tub, swimming pool or in a wet basement.
2. **Ventilation** – The unit should be situated so that its location or position does not interfere with its proper ventilation. For example, it should not be situated on a bed, sofa, rug or similar surface that may block ventilation openings. Also, it should not be placed in a built-in installation, such as a bookcase or cabinet, which may impede the flow of air through the ventilation openings.
3. **Heat** – The unit should be situated away from heat sources such as radiators, heat registers, stoves or other appliances (including amplifiers) that produce heat.
4. **Power Sources** – The unit should be connected to a power supply only of the type described in the operating instructions or as marked on the appliance.
5. **Power-Cable Protection** – Power supply cables should be routed so that they are not likely to be walked on or pinched by items placed upon or against them. It is always best to have a clear area from where the cable exits the unit to where it is plugged into an AC socket.
6. **Cleaning** – The unit should be cleaned only as recommended. See the Maintenance section of this manual for cleaning instructions.
7. **Objects and Liquid Entry** – Care should be taken so that objects do not fall and liquids are not spilled into any openings or vents located on the product.
8. **Attachments** – Do not use attachments not recommended by the product manufacturer.
9. **Lightning and Power Surge Protection** – Unplug the unit from the wall socket and disconnect the antenna or cable system during a lightning storm or when it is left unattended and unused for long periods of time. This will prevent damage to the product due to lightning and power-line surges.
10. **Overloading** – Do not overload wall sockets, extension cords, or integral convenience receptacles as this can result in a risk of fire or electric shock.
11. **Damage Requiring Service** – The unit should be serviced by qualified service personnel when:
 - A. the power supply cable or plug has been damaged.
 - B. objects have fallen into or liquid has been spilled into the enclosure.
 - C. the unit has been exposed to rain.
 - D. the unit has been dropped or the enclosure damaged.
 - E. the unit exhibits a marked change in performance or does not operate normally.
12. **Antenna** – Do not connect an external antenna to the unit (other than that provided).
13. **Periods of Nonuse** – If the unit is to be left unused for an extended period of time, such as a month or longer, the power cable should be unplugged from the unit to prevent damage or corrosion.
14. **Servicing** – The user should not attempt to service the unit beyond those methods described in the user's operating instructions. Service methods not covered in the operating instructions should be referred to qualified service personnel.

Questions? Visit www.ihomeintl.com

Trouble Shooting

Symptom	Possible Problem	Solution
Unit doesn't respond (no power)	AC adaptor isn't plugged to a wall outlet or the connector is not plugged into the power supply jack on the back of the unit	Plug the AC adaptor into a wall outlet and plug the connector into the power supply jack on the unit
	Wall outlet is not functioning	Plug another device into the same outlet to confirm the outlet is working
iPhone/iPod cannot dock properly	Using wrong insert	Make sure the dock insert is the proper fit for your iPhone/iPod
	Possible obstruction in dock area or on iPhone/iPod (skin or case is in the way)	Remove your iPhone/iPod from the connector and check for any obstruction on the connectors in the dock. Try removing case or skin from your iPhone/iPod. Then reseal it in the dock.
Playing iPhone/iPod but there is no sound	iPhone/iPod is not docked properly	Remove your iPhone/iPod from the connector and check for any obstruction on the connectors in the dock and on your iPhone/iPod. Then reseal it in the dock.
	Your iPhone/iPod is not playing	Press play button on your iPhone/iPod to play it manually.
	iPhone/iPod is locked up	Please make sure your iPhone/iPod is working properly before docking it to the unit. Please refer to your manual for details.
	Using 1 st or 2 nd generation iPod, iPod Shuffle or other device	Please connect them with Line-in.
iPhone/iPod didn't charge up	iPhone/iPod is not docked properly	Remove your iPhone/iPod from the connector and check for any obstruction on the connectors in the dock and on your iPhone/iPod. Then reseal it in the dock.
	iPhone/iPod is locked up/frozen	Please make sure your iPhone/iPod is working properly before docking it to the unit. Please refer to your manual for details.
	iPhone/iPod battery has problem	
Sound is distorted	Volume level is set too high	Decrease the unit volume
	Sound source is distorted	If original sound source file is poor quality, distortion and noise are easily noticed with high-power speakers. Try a file from a trusted audio source such as iTunes
		If you are using an iPod Shuffle or external sound source like older generation iPod, try reducing the output volume on the device itself. Also, try turning bass boost OFF under iPod settings.

iHome®